

North

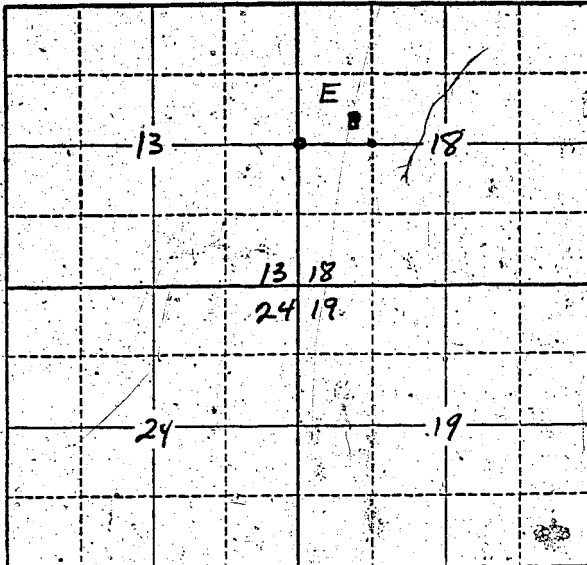

See attached Plat

Locate well and acreage of irrigated land on plat.

Scale: 2" = 1 Mile

STATE OF OREGON

County of Douglas } ss.

I, Elton J. Sybrant, being first duly sworn, do hereby certify that I have read the foregoing Registration Statement and that all of the items therein contained are true to the best of my knowledge and belief.

Elton J. Sybrant
(Signature of Registrant)

Subscribed and sworn to before me this June day of June, 1958

My commission expires March 24, 1960

Ernest A. Seaton
(Notary Public)

(SEAL)

CERTIFICATE OF REGISTRATION

STATE OF OREGON } ss.
County of Marion

This is to certify that the foregoing Registration Statement was received in the office of the State Engineer on the 7th day of July, 1958, at 8:00 o'clock A.M. and has been duly recorded in said office in Book No. 8 of Registration Statements on page GR-1858

Witness my hand this 26th day of January, 1959

Lewis A. Stanley
(State Engineer)

By _____ (Deputy)

\$1500