

Township 95 Range 10 W.M.
North

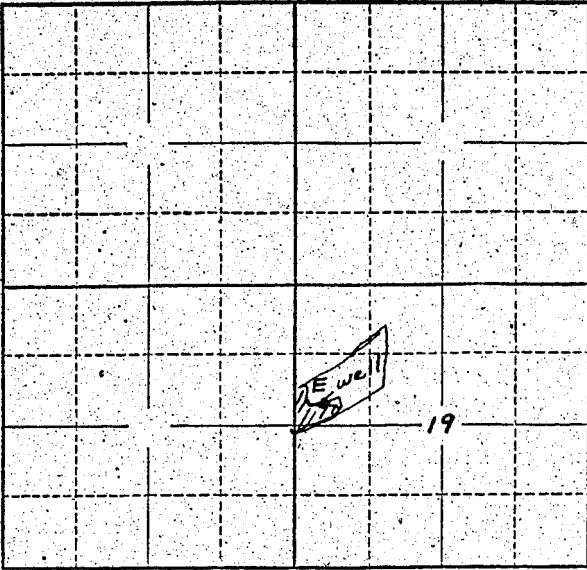

Locate well and acreage of irrigated land on plat.

Scale: 2" = 1 Mile

STATE OF OREGON

County of Marion } ss.

I, Carrie Hammer being first duly sworn, do hereby certify that I have read the foregoing Registration Statement and that all of the items therein contained are true to the best of my knowledge and belief.

Carrie Hammer
(Signature of Registrant)

Subscribed and sworn to before me this 7 day of June 1958

My commission expires June 19 1960
(Notary Public)

(SEAL)

CERTIFICATE OF REGISTRATION

STATE OF OREGON } ss.
County of Marion

This is to certify that the foregoing Registration Statement was received in the office of the State Engineer on the 9th day of June, 1958, at 1:00 o'clock P.M. and has been duly recorded in said office in Book No. 9 of Registration Statements on page GR-1922

Witness my hand this 9th day of February, 1959
Leura A. Stanley
(State Engineer)

By _____
(Deputy)

#15.00