

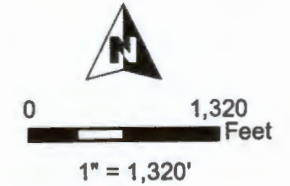

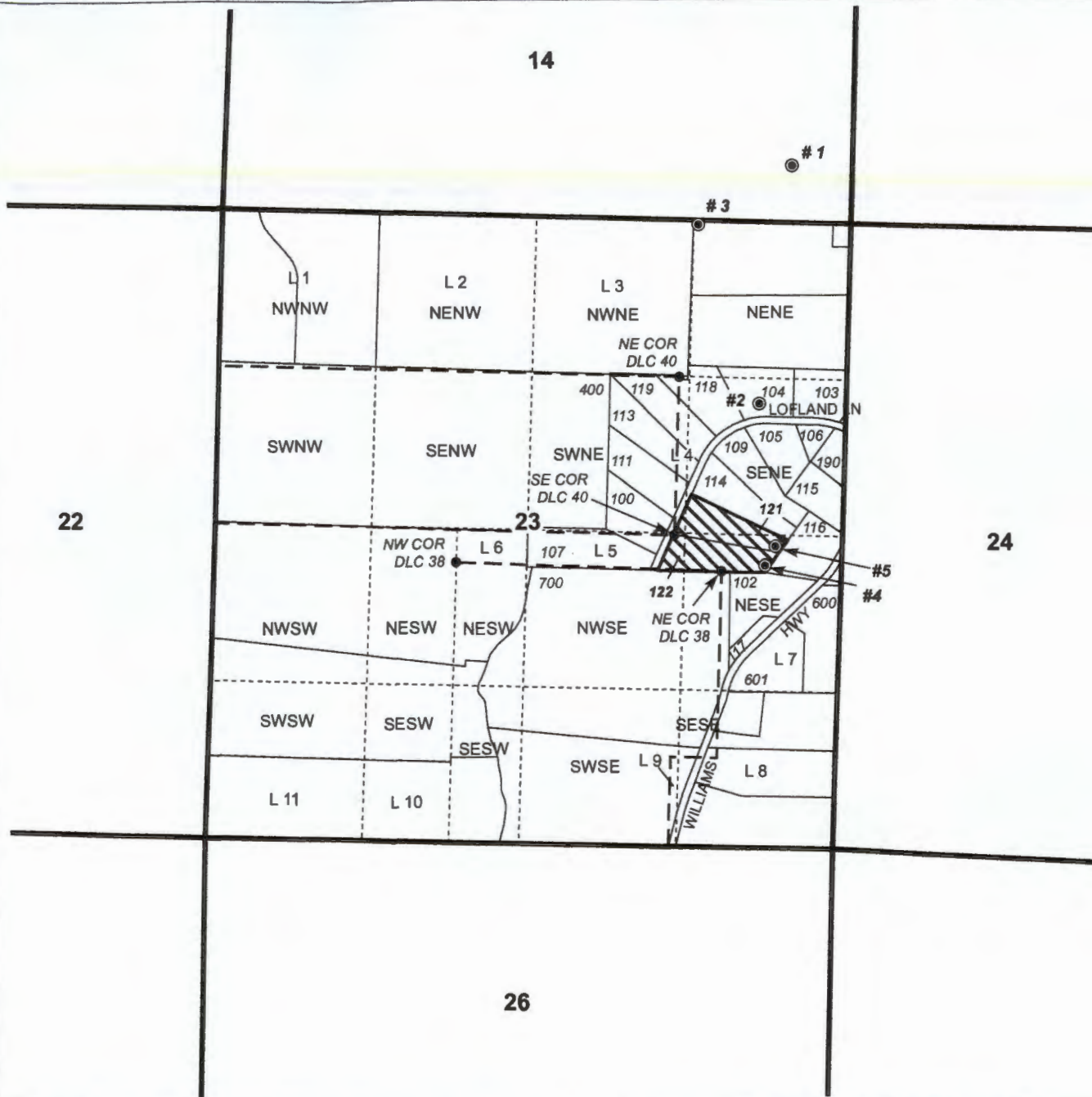





**T38S, R05W,
SECTION 23, WM**

JOSEPHINE COUNTY, OREGON



-  POU IR
-  Section
-  Tax Lot
-  Quarter Quarter
-  DLC Boundary
-  DLC Corner
-  POA

RECEIVED BY BOARD

APR 20 2016

SALEM, OR

POA LOCATIONS:

- #1: 498' N, 498' W OF SE COR SEC 14
- #2: 198' S, 744' W OF SE COR OF NENE 1/4 1/4 SEC 23
- #3: 1,300' W OF SE COR SEC 14
- #4: 240' S, 660' W OF E 1/4 COR SEC 23
- #5: 80' S, 570' W OF E 1/4 COR SEC 23

POU by QQ

- 3.1 AC in SENE
- 0.3 AC in SWNE
- 1.1 AC in NWSE
- 5.7 AC in NESE

RENEWAL DATE 12/31/2016



**GROUNDWATER REGISTRATION
MODIFICATION MAP**

GR-200

NOTE: THIS MAP IS NOT INTENDED TO
PROVIDE LEGAL DIMENSIONS OR LOCATIONS
OF PROPERTY OWNERSHIP LINES.

APRIL 8, 2016

WATER RIGHT SERVICES, LLC

PO BOX 1830, BEND, OR 97709

CCB# 197121 www.oregonwater.us

541-389-2837 JOHNSHORT@USA.COM

T-12349

Township 38 S Range 5 W, W.M.
North

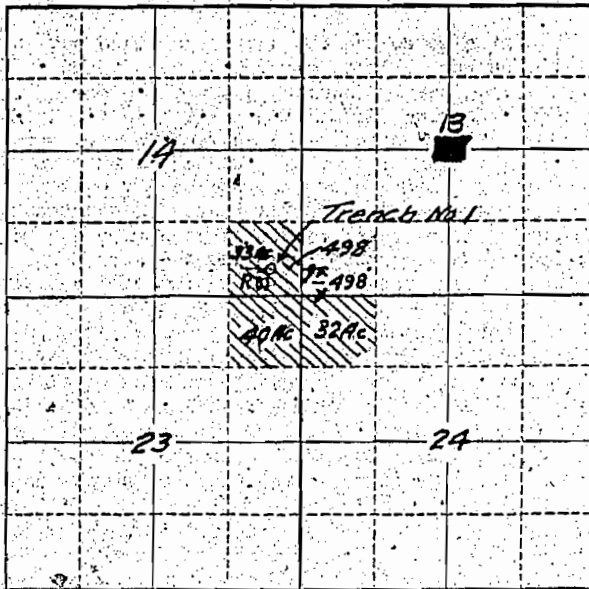

Locate well and acreage of irrigated land on plat.
Scale: 2" = 1 Mile

STATE OF OREGON

County of Jackson

ss.

J. R. F. Lofland & Maude Josephine Lofland, being first duly sworn, do hereby certify that I have read the foregoing Registration Statement and that all of the items therein contained are true to the best of my knowledge and belief.

J. R. F. Lofland
Maude Josephine Lofland
(Signature of Registrant)

Subscribed and sworn to before me this 19th day of June, 1956

My commission expires Jan. 22, 1960

W. C. Sandquist
(Notary Public)

(SEAL)

FOR CERTIFICATE OF REGISTRATION SEE PAGE GR-186 G
CERTIFICATE OF REGISTRATION

STATE OF OREGON

County of Marion

ss.

~~This is to certify that the foregoing Registration Statement was received in the office of the State Engineer on the 19th day of June, 1956, and that the same has been duly recorded in said office in Book No. 101 of Registration Statements on page 101.
Construction shall be completed by 1956 and the water completely applied to beneficial use by 1956.~~

Witness my hand this _____ day of _____, 19____

(State Engineer)

By _____ (Deputy)

GR - 186 C

Township 385 Range 5W, W.M.
North

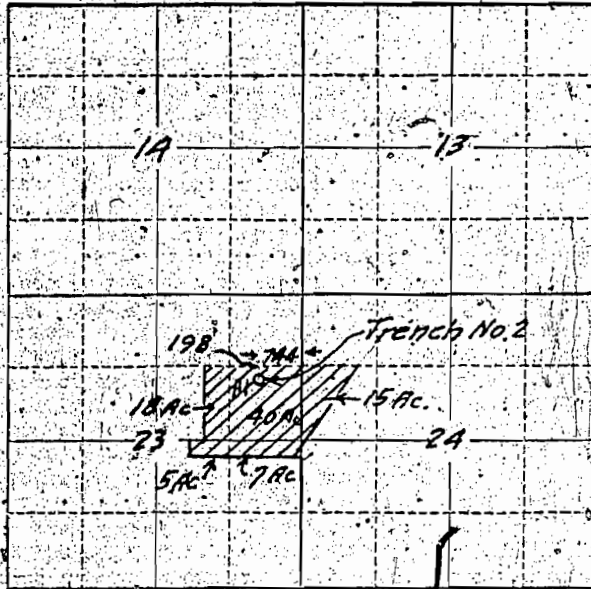

Locate well and acreage of irrigated land on plat.
Scale: 2" = 1 Mile

STATE OF OREGON

County of Jackson } ss.

I. R. F. Lofland & Maude Josephine Lofland, being first duly sworn, do hereby certify that I have read the foregoing Registration Statement and that all of the items therein contained are true to the best of my knowledge and belief.

R. F. Lofland
Maude Josephine Lofland
(Signature of Registrant)

Subscribed and sworn to before me this 19th day of June, 1956.

My commission expires Jan. 22, 1960

Cap. E. D. Dagnell
(Notary Public)

(SEAL)

CERTIFICATE OF REGISTRATION

STATE OF OREGON

County of Marion } ss.

This is to certify that the foregoing Registration Statement was received in the office of the State Engineer on the 21st day of June, 1956, at 8 o'clock A. M. and has been duly recorded in said office in Book No. 1 of Registration Statements on page GR-186 G.

~~Construction shall be completed by x-x-x-x-x-x-x-x-x-x-19- and the water completely applied to beneficial use by x-x-x-x-x-x-x-x-x-x-19-~~

Witness my hand this _____ day of _____, 1956.

Lewis A. Stanley
(State Engineer)

By _____ (Deputy)

GR-186 G