

Township 2S Range 2W W.M.  
North

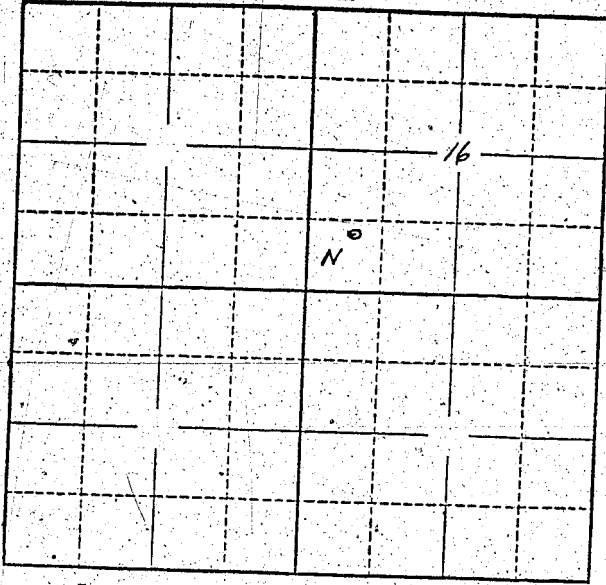

Locate well and acreage of irrigated land on plat.  
Scale: 2" = 1 Mile

STATE OF OREGON

County of \_\_\_\_\_ } ss.

I, George Hundland, being first duly sworn, do hereby certify that I have read the foregoing Registration Statement and that all of the items therein contained are true to the best of my knowledge and belief.

George Hundland Sec. Treas.  
(Signature of Registrant)

Subscribed and sworn to before me this 7th day of July, 1958

My commission expires 12th June 1961  
Wm. S. Bartholomew  
(Notary Public)

(SEAL)

**CERTIFICATE OF REGISTRATION**

STATE OF OREGON } ss.  
County of Marion

This is to certify that the foregoing Registration Statement was received in the office of the State Engineer on the 10th day of July, 1958, at 8.00 o'clock A.M. and has been duly recorded in said office in Book No. 9 of Registration Statements on page GR-1914

Witness my hand this 9th day of February, 1959

\$15.00

Lewia A. Stanley  
(State Engineer)

By \_\_\_\_\_  
(Deputy)

GR - 1914