

North

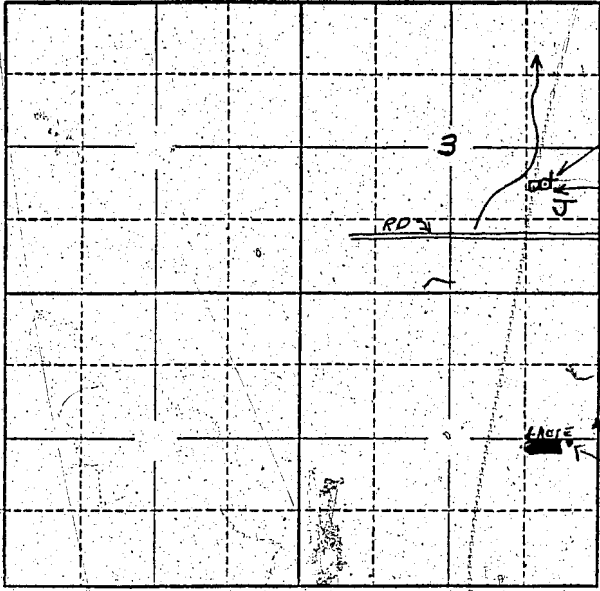

Locate well and acreage of irrigated land on plat.
Scale: 2" = 1 Mile

STATE OF OREGON

County of Lane } ss.

I, LAWRENCE SEUKAI, being first duly sworn, do hereby certify that I have read the foregoing Registration Statement and that all of the items therein contained are true to the best of my knowledge and belief.

Lawrence Seukai
(Signature of Registrant)

Subscribed and sworn to before me this 9th day of July, 1958

My commission expires Sept. 29, 1960

D. J. Young
(Notary Public)

(SEAL)

CERTIFICATE OF REGISTRATION

STATE OF OREGON

County of Marion } ss.

This is to certify that the foregoing Registration Statement was received in the office of the State Engineer on the 11th day of July, 1958, at 10 o'clock P.M. and has been duly recorded in said office in Book No. 16 of Registration Statements on page GR-3844

Witness my hand this 26th day of December, 1959

Lewis A. Stanley
(State Engineer)

By _____ (Deputy)

\$15.00