

NW 1/4 Section 25

Township 6 N Range 35 E, W.M.

North

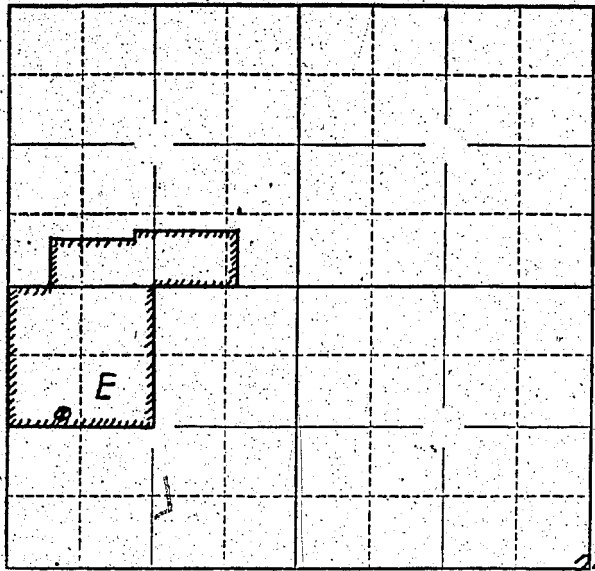

Well location  
332' E &  
13' N of  
SW corner  
of Property

Locate well and acreage of irrigated land on plat.

Scale:  $\frac{1}{8}$ " = 1 Mile

STATE OF OREGON

County of Umatilla } ss.

I, George Ranson, being first duly sworn, do hereby certify that I have read the foregoing Registration Statement and that all of the items therein contained are true to the best of my knowledge and belief.

Geo Ranson  
(Signature of Registrant)

Subscribed and sworn to before me this 9th day of July, 1958

My commission expires May 7, 1961

[Signature]  
(Notary Public) for Oregon

(SEAL)

**CERTIFICATE OF REGISTRATION**

STATE OF OREGON

County of Marion } ss.

This is to certify that the foregoing Registration Statement was received in the office of the State Engineer on the 14 day of July, 1958, at 8:00 o'clock A. M. and has been duly recorded in said office in Book No. 9 of Registration Statements on page GR-2015

~~Construction shall be completed by \_\_\_\_\_, 19\_\_\_\_, and the water completely applied to beneficial use by \_\_\_\_\_, 19\_\_\_\_.~~

Witness my hand this 9th day of February, 1959

Lewis A. Stanley  
(State Engineer)

\$15.00

By \_\_\_\_\_ (Deputy)

GR-2015