

Township 6 Range 1 W W.M. Buttalas plotted addition to City of Mt. Aggel North

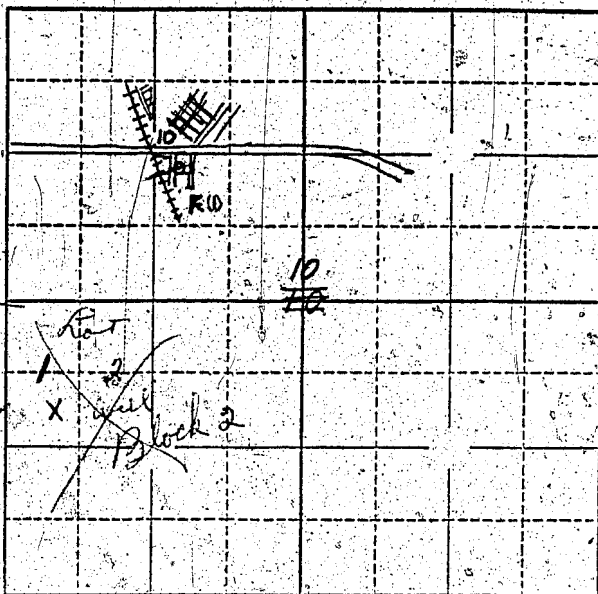

Locate well and acreage of irrigated land on plat.

Scale: 2" = 1 Mile

STATE OF OREGON

County of Marion } ss.

I, Joseph J. Bechtold, being first duly sworn, do hereby certify that I have read the foregoing Registration Statement and that all of the items therein contained are true to the best of my knowledge and belief.

By Joseph J. Bechtold Manager (Signature of Registrant)

Subscribed and sworn to before me this 3rd day of October, 1955

My commission expires Sept 22 1958 Hans Ham (Notary Public)

(SEAL)

CERTIFICATE OF REGISTRATION

STATE OF OREGON

County of Marion } ss.

This is to certify that the foregoing Registration Statement was received in the office of the State Engineer on the 5th day of October, 1955 at 1:00 o'clock P.M. and has been duly recorded in said office in Book No. 1 of Registration Statements on page 18

Construction shall be completed by 1956, and the water completely applied to beneficial use by 1956

Witness my hand this 24th day of February, 1956 Lewis A. Stanley (State Engineer)

By (Deputy)