

Township 6 N Range 35 E W.M.
 NE 1/4 of NW 1/4 North of NE 1/4 Section 35

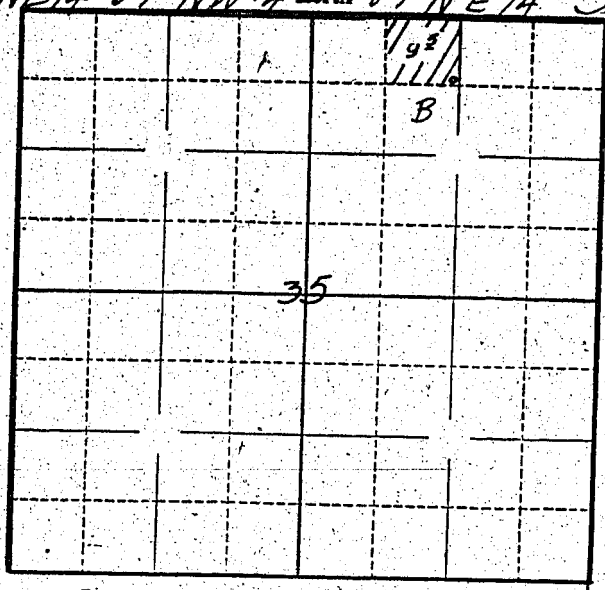

30 ft West
 17 ft North of
 South East
 Property Corner

Locate well and acreage of irrigated land on plat.
 Scale: $\frac{1}{2}$ - 1 Mile

STATE OF OREGON

County of Umatilla } ss.

I, Paul Redfearn, being first duly sworn, do hereby certify that I have read the foregoing Registration Statement and that all of the items therein contained are true to the best of my knowledge and belief.

Paul Redfearn
 (Signature of Registrant)

Subscribed and sworn to before me this 6 day of March, 1958

My commission expires Sept 8, 1960

Chris L. Shuler
 (Notary Public)

(SEAL)

CERTIFICATE OF REGISTRATION

STATE OF OREGON } ss.
 County of Marion

This is to certify that the foregoing Registration Statement was received in the office of the State Engineer on the 14 day of July, 1958, at 8:00 o'clock A. M. and has been duly recorded in said office in Book No. 9 of Registration Statements on page GR 2019

Witness my hand this 9th day of February, 1959

Lewis A. Stanley
 (State Engineer)

By _____ (Deputy)

GR-2019

\$15.00