

Township 1 N Range 3 E W.M.  
15 North

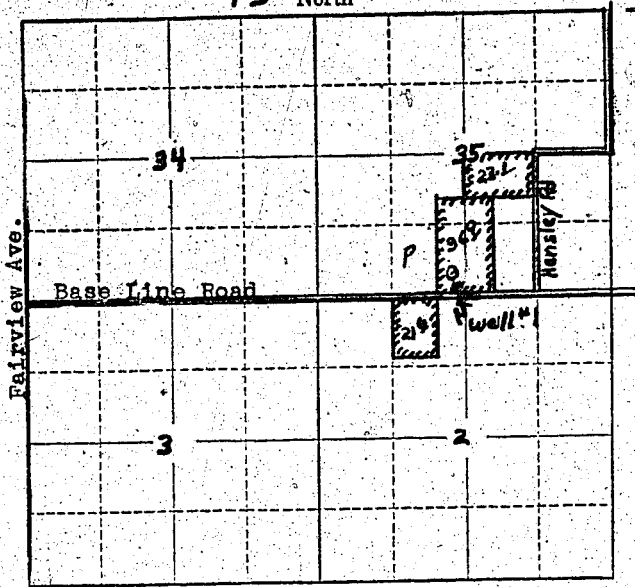

Locate well and acreage of irrigated land on plat.  
 Scale: 2" = 1 Mile

STATE OF OREGON

County of Multnomah } ss.

I, Eldon Snider, being first duly sworn, do hereby certify that I have read the foregoing Registration Statement and that all of the items therein contained are true to the best of my knowledge and belief.

*Eldon Snider*  
 (Signature of Registrant)

Subscribed and sworn to before me this 9th day of May, 19 58.

My commission expires MY COMMISSION EXPIRES SEPT. 23, 1960

(Notary Public)

(SEAL)

**CERTIFICATE OF REGISTRATION**

STATE OF OREGON

County of Marion } ss.

This is to certify that the foregoing Registration Statement was received in the office of the State Engineer on the 14 day of July, 19 58, at 8:00 o'clock A. M. and has been duly recorded in said office in Book No. 9 of Registration Statements on page GR-2036

~~Registration shall be completed by 10:00 a.m. and the order completely executed or~~  
~~referred to by 10:00 a.m.~~

Witness my hand this 16th day of February, 19 59.

*Lewis A. Stanley*  
 (State Engineer)

By \_\_\_\_\_ (Deputy)

# 32.30

GR-2036