

Township 17.5 Range 4 W, W.M.  
North.

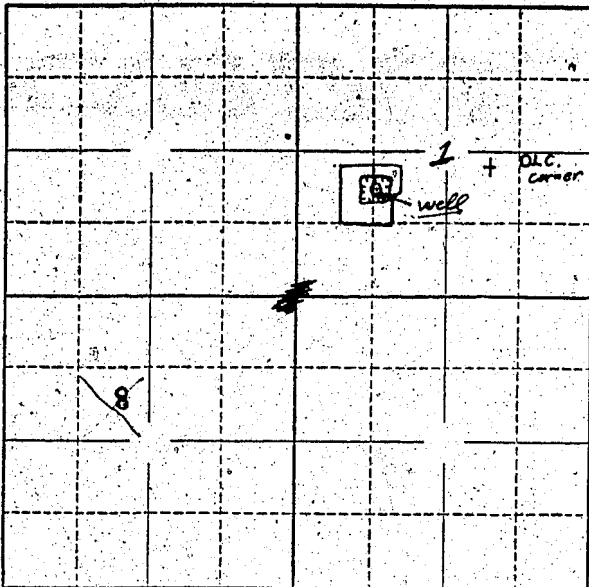

Locate well and acreage of irrigated land on plat.

Scale: 2" = 1 Mile

STATE OF OREGON

County of Lane } ss.

I, Ralph E. Clark, being first duly sworn, do hereby certify that I have read the foregoing Registration Statement and that all of the items therein contained are true to the best of my knowledge and belief.

Ralph E. Clark - Grace A. Clark  
(Signature of Registrant)

Subscribed and sworn to before me this 11 day of July, 1958

My commission expires Sept. 29, 1958

D. B. Young  
(Notary Public)

(SEAL)

**CERTIFICATE OF REGISTRATION**

STATE OF OREGON

County of Marion } ss.

This is to certify that the foregoing Registration Statement was received in the office of the State Engineer on the 14 day of July, 1958, at 8:00 o'clock A. M. and has been duly recorded in said office in Book No. 16 of Registration Statements on page GP-3893

Witness my hand this 15<sup>th</sup> day of February, 1960

Lewis A. Stanley  
(State Engineer)

By \_\_\_\_\_ (Deputy)

GR 3893

\$15.00