

Township 15 S Range 4 W, W.M.
North

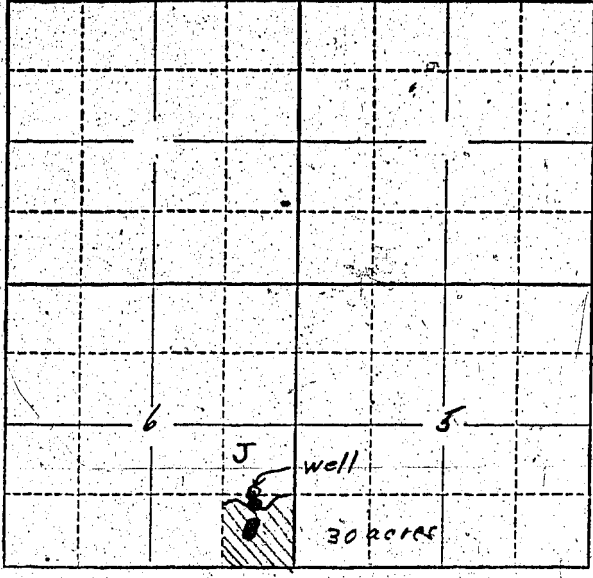

Locate well and acreage of irrigated land on plat.
Scale: 2" = 1 Mile

STATE OF OREGON }
County of Lane } ss.

I, G. W. FOACHT, being first duly sworn, do hereby certify that I have read the foregoing Registration Statement and that all of the items therein contained are true to the best of my knowledge and belief.

G. W. Foacht
(Signature of Registrant)

Subscribed and sworn to before me this 14th day of March, 1958

My commission expires Jan 25, 1961
Luelle A. Hinson
(Notary Public)

(SEAL)

CERTIFICATE OF REGISTRATION

STATE OF OREGON }
County of Marion } ss.

This is to certify that the foregoing Registration Statement was received in the office of the State Engineer on the 15th day of July, 1958, at 2:00 o'clock A. M. and has been duly recorded in said office in Book No. 9 of Registration Statements on page GR-2050

~~Construction shall be completed by _____ and the water completely applied to beneficial use by _____~~

Witness my hand this 16th day of February, 1959

Lewis A. Stanley
(State Engineer)

By _____
(Deputy)

GR-2050

\$15.00