

Township 9S Range 2W, W.M.
North

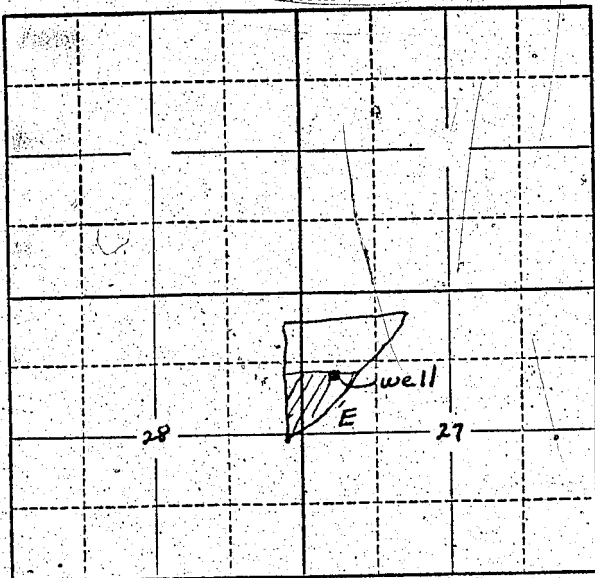

Locate well and acreage of irrigated land on plat.

Scale: 2" = 1 Mile

STATE OF OREGON

County of William H. Watson } ss.

I, William H. Watson, being first duly sworn, do hereby certify that I have read the foregoing Registration Statement and that all of the items therein contained are true to the best of my knowledge and belief.

William H. Watson
(Signature of Registrant)

Subscribed and sworn to before me this 15th day of July, 1958.

My commission expires 12th June 1961

Wm. S. Bantolone
(Notary Public)

(SEAL)

CERTIFICATE OF REGISTRATION

STATE OF OREGON

County of Marion } ss.

This is to certify that the foregoing Registration Statement was received in the office of the State Engineer on the 15th day of July, 1958, at 11:45 o'clock A M. and has been duly recorded in said office in Book No. 9 of Registration Statements on page GR-2072

Witness my hand this 16th day of February, 1959

Erwin A. Stanley
(State Engineer)

By _____ (Deputy)

\$15.00