

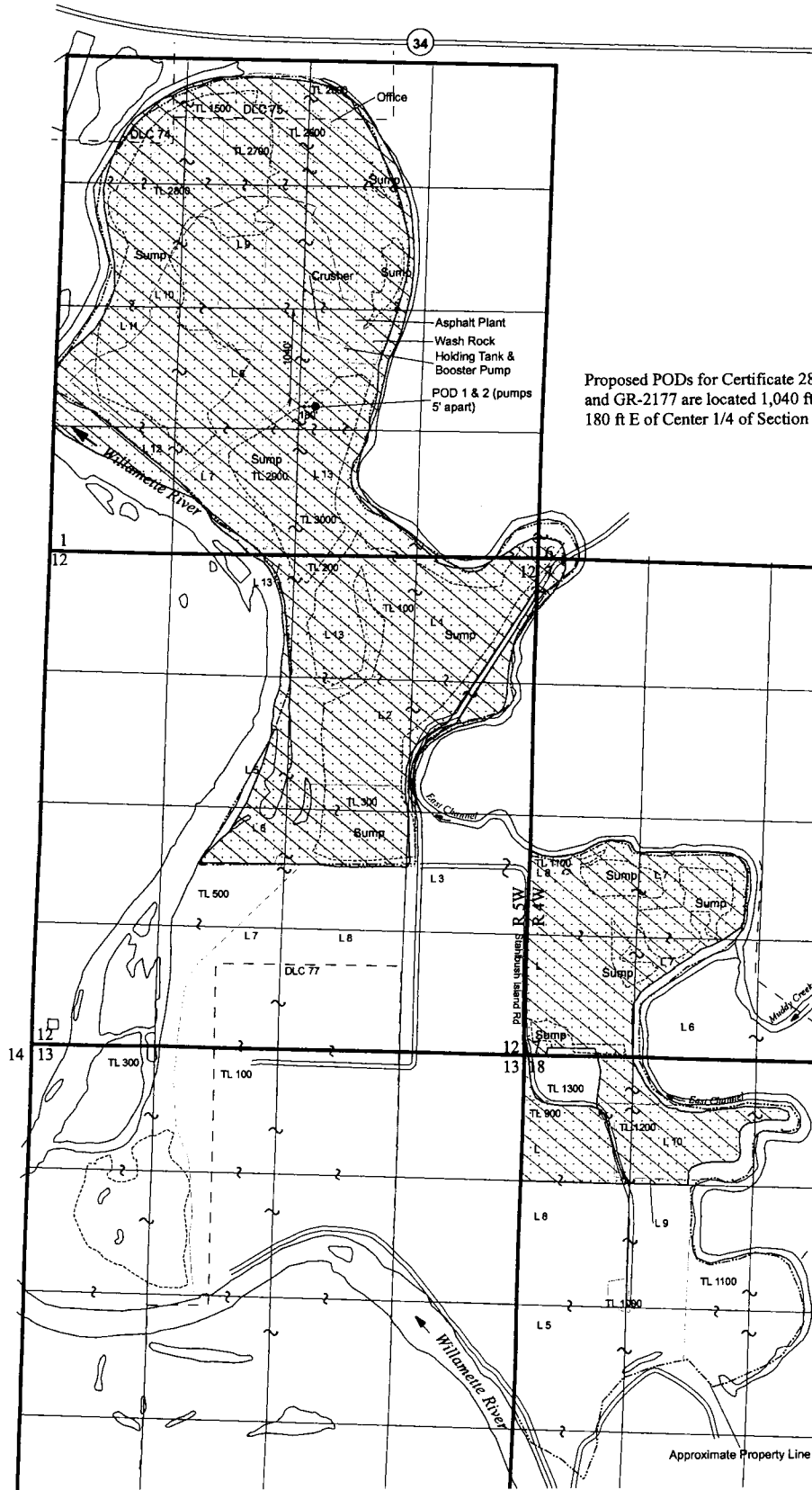

T12S, R4W & 5W, Sections 1, 6, 7, 12, & 18, WM  
 Linn County, Oregon  
 To Map



Proposed PODs for Certificate 28783 and GR-2177 are located 1,040 ft S and 180 ft E of Center 1/4 of Section 1.

**To Lands**

 Certificate 28783 POU with Addition of PODs 1 & 2 in NWSE Sec. 1

 GR-2177 POU with Addition of PODs 1 & 2 in NWSE Sec. 1

THIS MAP IS NOT INTENDED TO PROVIDE LEGAL DIMENSIONS OR LOCATIONS OF PROPERTY OWNERSHIP LINES.

April 1, 2009

*EnviroLogic Resources, Inc.*

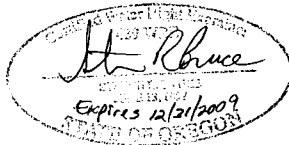

RECEIVED  
 APR 24 2009

WATER RESOURCES  
 SALEM, OREGON



1 inch = 1,320 feet

FIGURE 2

KNIFE RIVER  
 Corvallis, Oregon

T 10859

Township 12S Range 4W, W.M.  
North

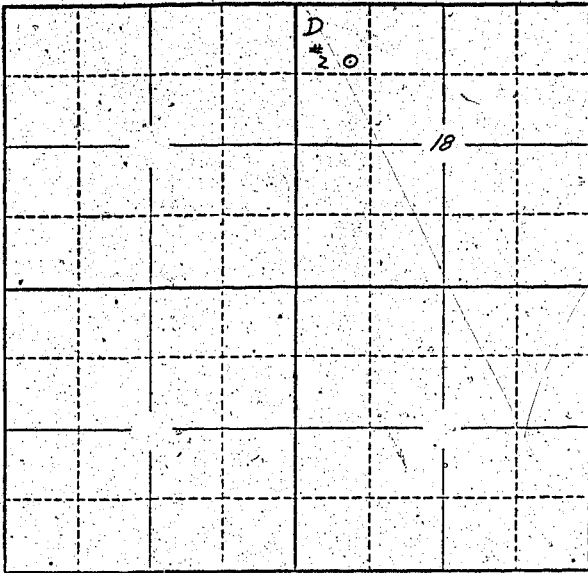

Locate well and acreage of irrigated land on plat.  
Scale: 2" = 1 Mile

STATE OF OREGON

County of Marion } ss.

I, Thad F. Neville, being first duly sworn, do hereby certify that I have read the foregoing Registration Statement and that all of the items therein contained are true to the best of my knowledge and belief.

Thad F. Neville  
(Signature of Registrant)

Subscribed and sworn to before me this 15th day of July, 1958

My commission expires 12th June 1961 Wm. S. Bartholomew  
(Notary Public)

(SEAL)

**CERTIFICATE OF REGISTRATION**

STATE OF OREGON } ss.  
County of Marion

This is to certify that the foregoing Registration Statement was received in the office of the State Engineer on the 15th day of July, 1958, at 8:30 o'clock A. M. and has been duly recorded in said office in Book No. 9 of Registration Statements on page GR-2086

Witness my hand this 16th day of February, 1959.  
Lewis A. Stanley  
(State Engineer)

By \_\_\_\_\_  
(Deputy)

\$15.00