

North

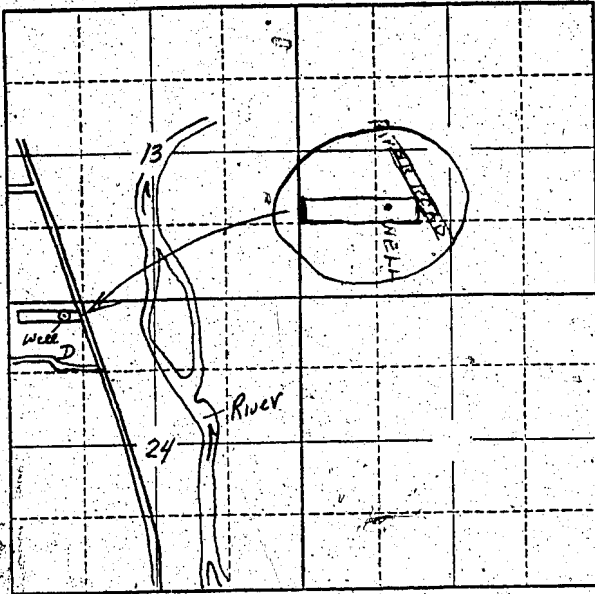

Locate well and acreage of irrigated land on plat.

Scale: 2" = 1 Mile

STATE OF OREGON

County of Marion } ss.

I, Raymond Woodruff, being first duly sworn, do hereby certify that I have read the foregoing Registration Statement and that all of the items therein contained are true to the best of my knowledge and belief.

Raymond Woodruff  
(Signature of Registrant)

Subscribed and sworn to before me this 16th day of July, 1958

My commission expires June 18, 1958 W. C. ...  
(Notary Public)

(SEAL)

**CERTIFICATE OF REGISTRATION**

STATE OF OREGON

County of Marion } ss.

This is to certify that the foregoing Registration Statement was received in the office of the State Engineer on the 16th day of July, 1958, at 2:00 o'clock A. M. and has been duly recorded in said office in Book No. 016 of Registration Statements on page GR-3859

Witness my hand this 28th day of December, 1959

W. C. ...  
(State Engineer)

By \_\_\_\_\_ (Deputy)

GR 3859

\$15.00