

Township 15 North Range 25 W.M.

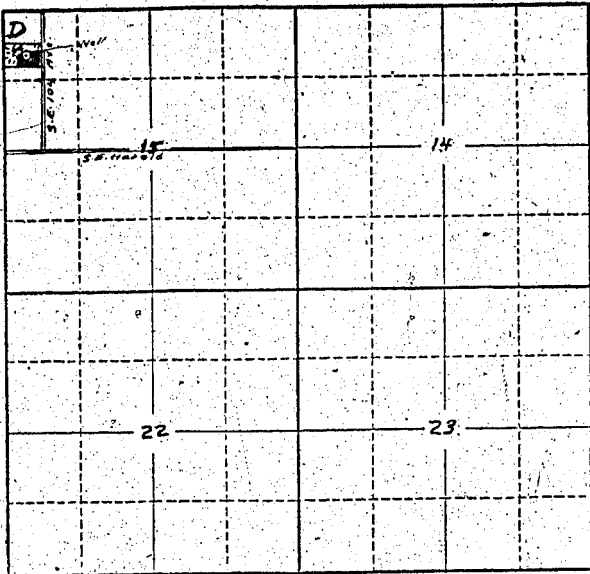

Locate well and acreage of irrigated land on plat. Scale: 2" = 1 Mile

STATE OF OREGON

County of Multnomah

ss.

I, Mary E. Merrill being first duly sworn, do hereby certify that I have read the foregoing Registration Statement and that all of the items therein contained are true to the best of my knowledge and belief.

being first duly sworn, do hereby certify that I have read the foregoing Registration Statement and that all of the items therein contained are true to the best of my knowledge and belief.

Mary E. Merrill (Signature of Registrant)

Subscribed and sworn to before me this 15th day of July, 1958

My commission expires Jan. 11, 1961 (Notary Public)

(SEAL)

CERTIFICATE OF REGISTRATION

STATE OF OREGON County of Marion ss.

This is to certify that the foregoing Registration Statement was received in the office of the State Engineer on the 16th day of July, 1958, at 2:00 o'clock A.M. and has been duly recorded in said office in Book No. 9 of Registration Statements on page GR-2094

Witness my hand this 16th day of February, 1959 Lewis A. Stanley (State Engineer)

By (Deputy)

\$1,500.