

North

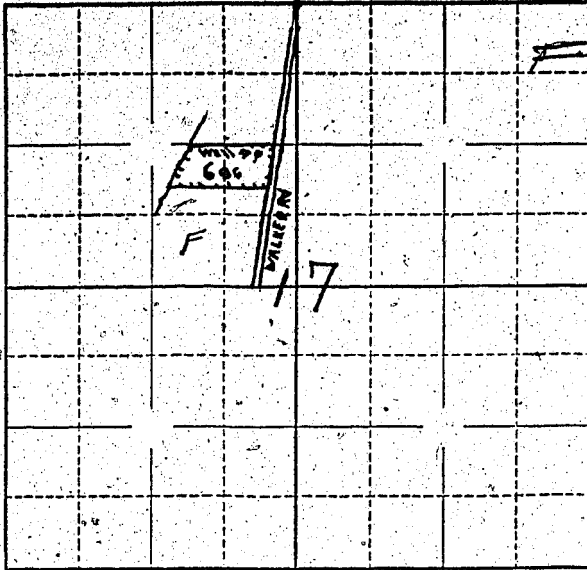

Locate well and acreage of irrigated land on plat.

Scale: 2" = 1 Mile

4"

STATE OF OREGON

County of Marion } ss.

I, Wm. P. Phillips, being first duly sworn, do hereby certify that I have read the foregoing Registration Statement and that all of the items therein contained are true to the best of my knowledge and belief.

Wm. P. Phillips
(Signature of Registrant)

Subscribed and sworn to before me this 17th day of July, 1958.

My commission expires 12th June 1961 Wm. S. Bartholomew
(Notary Public)

(SEAL)

CERTIFICATE OF REGISTRATION

STATE OF OREGON } ss.
County of Marion

This is to certify that the foregoing Registration Statement was received in the office of the State Engineer on the 17th day of July, 1958, at 11:20 o'clock A. M. and has been duly recorded in said office in Book No. 9 of Registration Statements on page GR-2133.

Witness my hand this 10th day of March, 1959.

Lewis A. Stanley
(State Engineer)

By _____
(Deputy)

\$15.00