

North

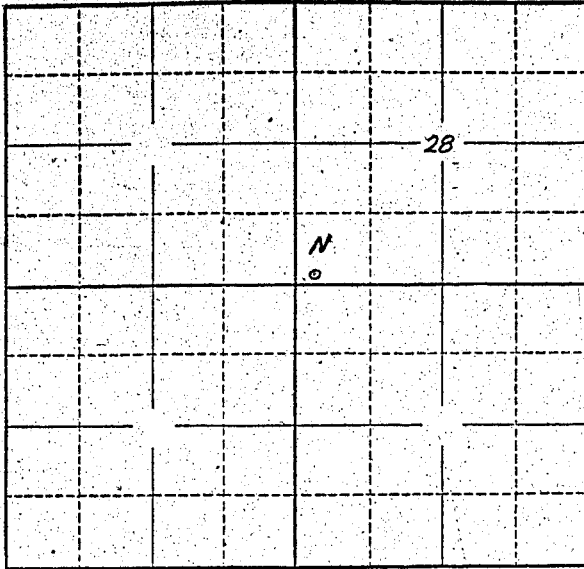

Locate well and acreage of irrigated land on plat.

Scale: 2" = 1 Mile

STATE OF OREGON

County of Linn } ss.

I, Lyle Bowers, being first duly sworn, do hereby certify that I have read the foregoing Registration Statement and that all of the items therein contained are true to the best of my knowledge and belief.

Lyle Bowers
(Signature of Registrant)

Subscribed and sworn to before me this 16 day of July, 1958

My commission expires July 28, 1958

Grant Farris
(Notary Public)

(SEAL)

CERTIFICATE OF REGISTRATION

STATE OF OREGON }
County of Marion } ss.

This is to certify that the foregoing Registration Statement was received in the office of the State Engineer on the 18th day of July, 1958, at 2:00 o'clock A.M. and has been duly recorded in said office in Book No. 10 of Registration Statements on page GR 2194

Witness my hand this 10th day of March

19 59

Lewis A. Stanley
(State Engineer)

By _____ (Deputy)

\$15.00