

D.L.C. #51

Township 27S Range 6W W.M.

North

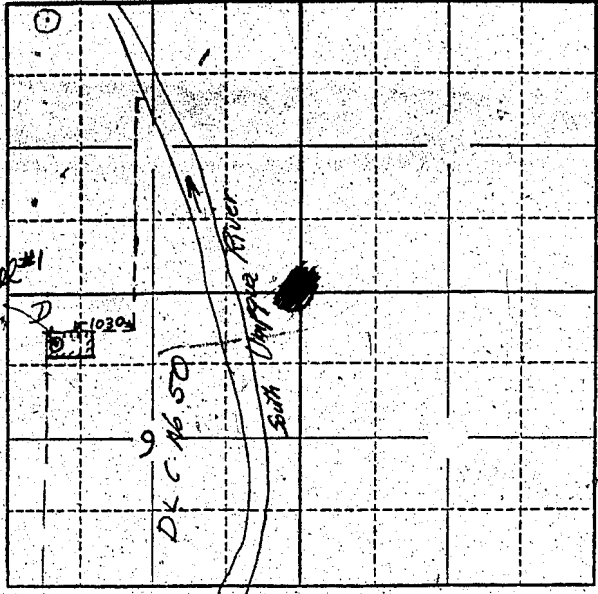

Locate well and acreage of irrigated land on plat.  
Scale: 2" = 1 Mile

STATE OF OREGON  
County of Douglas

ss.

I, Pete Veenstra, being first duly sworn, do hereby certify that I have read the foregoing Registration Statement and that all of the items therein contained are true to the best of my knowledge and belief.

*Pete Veenstra*  
(Signature of Registrant)

Subscribed and sworn to before me this 17th day of July, 1958

My commission expires 6/30/60

*H. Thompson*  
(Notary Public)

(SEAL)

**CERTIFICATE OF REGISTRATION**

STATE OF OREGON  
County of Marion

ss.

This is to certify that the foregoing Registration Statement was received in the office of the State Engineer on the 18th day of July, 1958, at 8:00 o'clock A. M. and has been duly recorded in said office in Book No. 16 of Registration Statements on page GR-3899

Witness my hand this 15th day of February, 1960

*Laura A. Stanley*  
(State Engineer)

By \_\_\_\_\_  
(Deputy)

15.00