

Legal Description of Property

North

Beginning at a point on the West line of and North 0° 02' East, 1803.22 Feet from the Southwest corner of Donation Land Claim #67, in Township 37 South, Range 2 West of the Willamette Meridian in Jackson County, Oregon; thence along said line, North 0° 02' East, 442.2 Feet; thence East, 368.52 feet to the Westerly line of road; thence along said line, South 39° 50' West, 575.00 feet to the point of beginning.

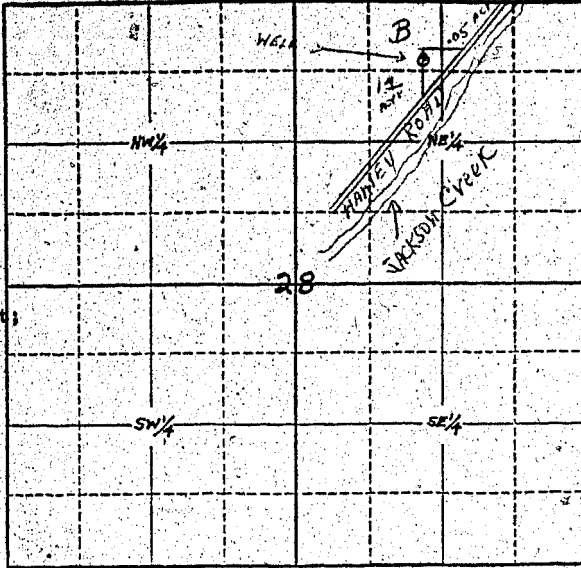

Locate well and acreage of irrigated land on plat. Scale: 4" = 1 Mile

STATE OF OREGON

County of Jackson

} ss.

I, Harold L. Wall being first duly sworn, do hereby certify that I have read the foregoing Registration Statement and that all of the items therein contained are true to the best of my knowledge and belief.

Harold L. Wall
(Signature of Registrant)

Subscribed and sworn to before me this 14th day of July, 1958

My commission expires June 25, 1958

Paul McHugh
(Notary Public)

(SEAL)

CERTIFICATE OF REGISTRATION

STATE OF OREGON

County of Marion

} ss.

This is to certify that the foregoing Registration Statement was received in the office of the State Engineer on the 18th day of July, 1958, at 8:00 o'clock A. M. and has been duly recorded in said office in Book No. 10 of Registration Statements on page GR 2205

Witness my hand this 10th day of March, 1959

Lewia A. Stanley
(State Engineer)

By _____ (Deputy)

7/500