

Township 6 S Range 1 W, W.M.
North

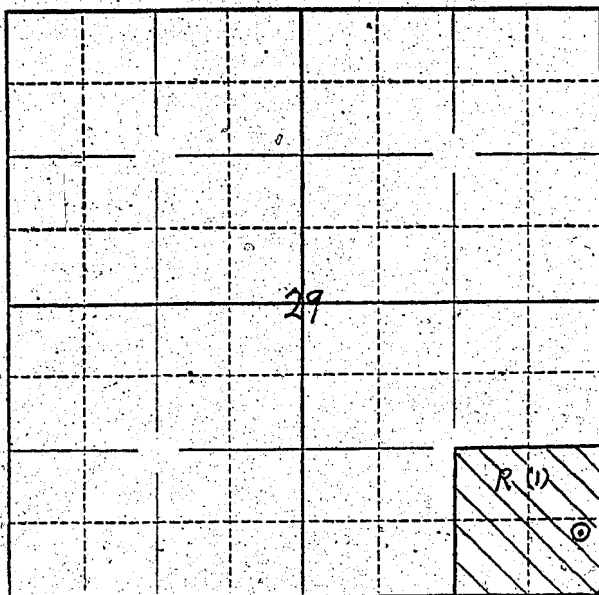

Locate well and acreage of irrigated land on plat.

Scale: $\frac{1}{4}$ " = 1 Mile

STATE OF OREGON

County of Marion

} ss.

I, Archie R. Eberhardt and Elsie E. Eberhardt, being first duly sworn, do hereby certify that I have read the foregoing Registration Statement and that all of the items therein contained are true to the best of my knowledge and belief.

Archie R. Eberhardt
Elsie E. Eberhardt
(Signature of Registrant)

Subscribed and sworn to before me this 28th day of October, 1955.

My commission expires May 17, 1958

C. B. Johnson
(Notary Public)

For State of Oregon

(SEAL)

CERTIFICATE OF REGISTRATION

STATE OF OREGON

County of Marion

} ss.

This is to certify that the foregoing Registration Statement was received in the office of the State Engineer on the 28th day of October, 1955, at 10:15 o'clock A. M. and has been duly recorded in said office in Book No. 1 of Registration Statements on page 24

Construction shall be completed by 15, 1955, and the water completely applied to beneficial use by 15, 1955.

Witness my hand this 24th day of February, 1956

Lewis A. Stanley
(State Engineer)

By

(Deputy)