

Township 1N Range 3E W.M.
North

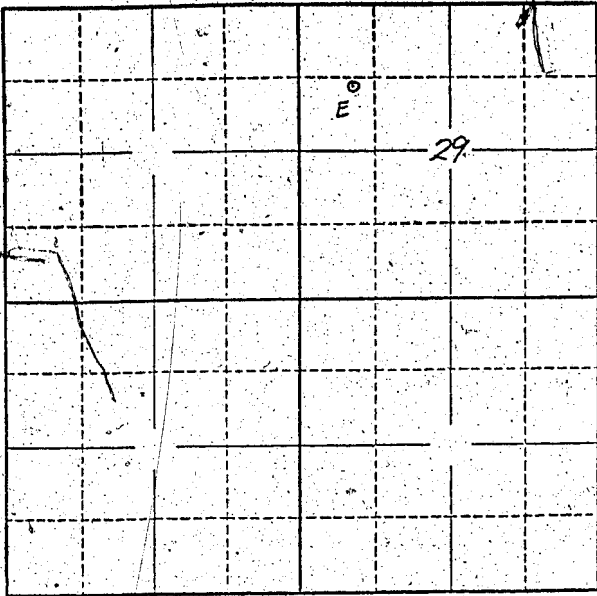

Locate well and acreage of irrigated land on plat.
Scale: 2" = 1 Mile

STATE OF OREGON }
County of Multnomah } ss.

I, Daniel P. Schmidt being first duly sworn, do hereby certify that I have read the foregoing Registration Statement and that all of the items therein contained are true to the best of my knowledge and belief.

Daniel P. Schmidt
(Signature of Registrant)

Subscribed and sworn to before me this 28th day of July, 1958

My commission expires Mar. 8, 1959

Conrad Ehl
(Notary Public)

(SEAL)

CERTIFICATE OF REGISTRATION

STATE OF OREGON }
County of Marion } ss.

This is to certify that the foregoing Registration Statement was received in the office of the State Engineer on the 29th day of July, 1958, at 8:00 o'clock A. M. and has been duly recorded in said office in Book No. 12 of Registration Statements on page GR-2823

Witness my hand this 25th day of May, 1959

Lewis A. Stanley
(State Engineer)

#1500

By _____
(Deputy)

GR - 2823