

Township 16 S Range 4W, W.M.
North

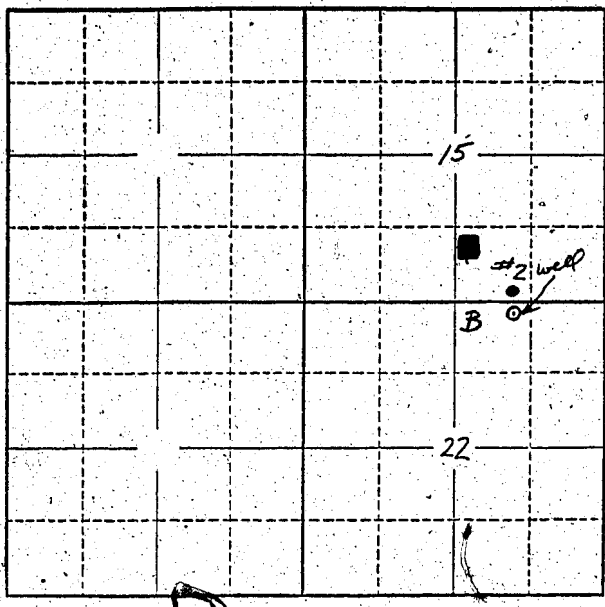

Locate well and acreage of irrigated land on plat
Scale: 2" = 1 Mile

STATE OF OREGON
County of Wane } ss.

I, Edward C. Falk Jr., being first duly sworn, do hereby certify that I have read the foregoing Registration Statement and that all of the items therein contained are true to the best of my knowledge and belief.

Edward C. Falk Jr.
(Signature of Registrant)

Subscribed and sworn to before me this 18th day of April, 1958.

My commission expires March 19, 1962
Wesley J. Boyard
(Notary Public)

(SEAL)

CERTIFICATE OF REGISTRATION

STATE OF OREGON } ss.
County of Marion

This is to certify that the foregoing Registration Statement was received at the office of the State Engineer on the 30th day of July, 1958, at 8.00 o'clock A. M. and has been duly recorded in said office in Book No. 12 of Registration Statements on page GR-2892

Witness my hand this 25th day of May, 1959

Laura A. Stanley
(State Engineer)

By _____
(Deputy)

\$15.00