

North

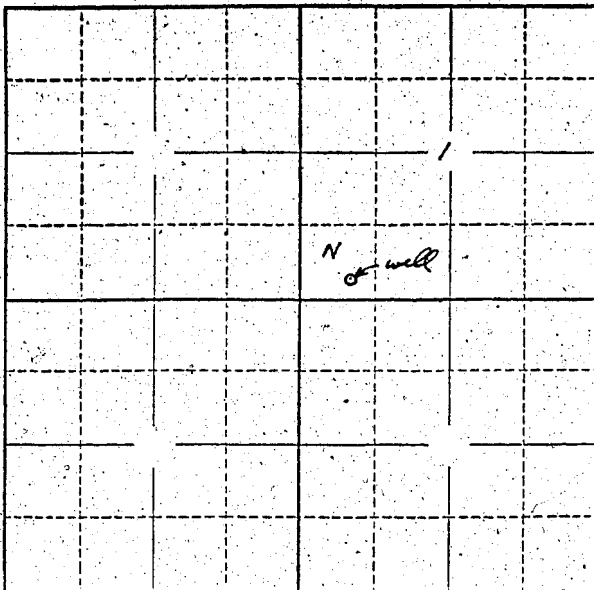

Locate well and acreage of irrigated land on plat.

Scale: 2" = 1 Mile

STATE OF OREGON

County of MULTNOMAH } ss.

I, M. W. WEBBER, being first duly sworn, do hereby certify that I have read the foregoing Registration Statement and that all of the items therein contained are true to the best of my knowledge and belief.

M. W. Webber
(Signature of Registrant)

Subscribed and sworn to before me this 28th day of July, 1952

My commission expires 11-25-58

[Signature]
(Notary Public)

(SEAL)

NOTARY PUBLIC FOR OREGON
My Commission Expires Nov. 25, 1958

CERTIFICATE OF REGISTRATION

STATE OF OREGON }
County of Marion } ss.

This is to certify that the foregoing Registration Statement was received in the office of the State Engineer on the 30th day of July, 1952, at 2:00 o'clock A.M. and has been duly recorded in said office in Book No. 12 of Registration Statements on page GR-2930

Witness my hand this 25th day of May, 1959

[Signature]
(State Engineer)

By _____ (Deputy)

\$15.00