

North

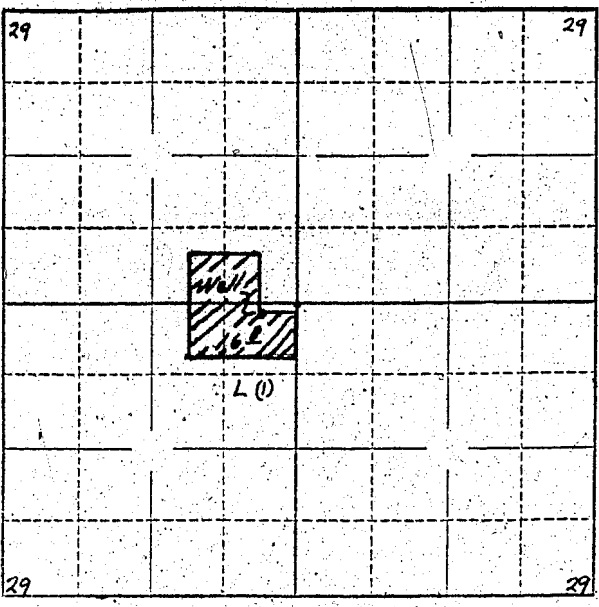

Locate well and acreage of irrigated land on plat.

Scale: 2" = 1 Mile 4" = 1 Mile

STATE OF OREGON

County of Oregon } ss.

I, Roy C. Terry, being first duly sworn, do hereby certify that I have read the foregoing Registration Statement and that all of the items therein contained are true to the best of my knowledge and belief.

(Signature of Registrant)

Subscribed and sworn to before me this 12th day of December, 1956.

NOTARY PUBLIC FOR OREGON

My commission expires My Commission Expires Jan. 18, 1958

(Notary Public)

(SEAL)

CERTIFICATE OF REGISTRATION

STATE OF OREGON

County of Marion } ss.

This is to certify that the foregoing Registration Statement was received in the office of the State Engineer on the 12th day of December, 1956, at 9 o'clock A.M. and has been duly recorded in said office in Book No. 2 of Registration Statements on page GR-294-C.

~~Construction shall be completed by 1957 and the water completely available to~~

Witness my hand this 15th day of January, 1957.

(Signature of Lewis A. Stanley) State Engineer

By (Deputy)

GR-294C