

Well is Located:

151 feet south and 105 feet west of 1" pipe at NE corner of land deeded to A. G. Linn by Benton County which corner is 840' S 89°57' W along claim line and 76.32' S parallel to the E line from the NE corner of Prior Scott D.L.C.#44, T. 25.R. 5W. Benton County, Oregon. One inch pipe and well marked in red on attached map

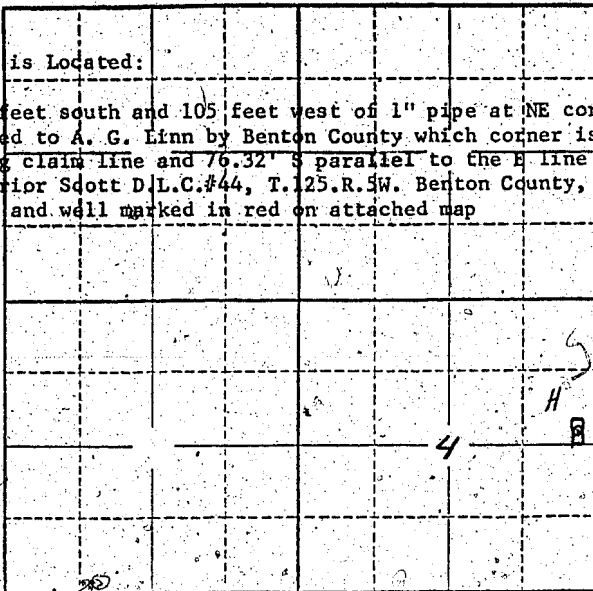

Locate well and acreage of irrigated land on plat.

Scale: 2" = 1 Mile

STATE OF OREGON

County of Benton

ss.

I, D. E. Bullis, being first duly sworn, do hereby certify that I have read the foregoing Registration Statement and that all of the items therein contained are true to the best of my knowledge and belief.

D. E. Bullis
(Signature of Registrant)

Subscribed and sworn to before me this 28th day of July, 1958.

NOTARY PUBLIC FOR OREGON

My commission expires My Commission Expires Aug. 21, 1960

W. M. Lawrence
(Notary Public)

(SEAL)

CERTIFICATE OF REGISTRATION

STATE OF OREGON

County of Marion

ss.

This is to certify that the foregoing Registration Statement was received in the office of the State Engineer on the 30th day of July, 1958, at 8:00 o'clock A.M. and has been duly recorded in said office in Book No. 12 of Registration Statements on page GR-2938

Witness my hand this 25th day of May, 1959.

Laura A. Stanley
(State Engineer)

By _____ (Deputy)

\$15.00