

Township 16 S Range 5 W, W.M.
North

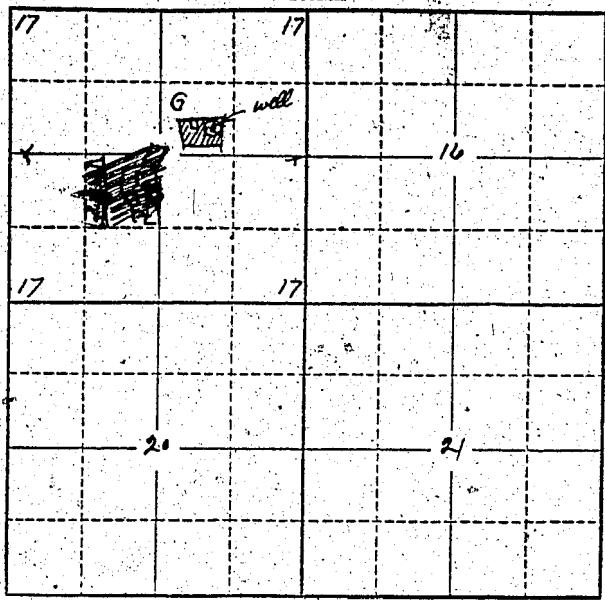

Locate well and acreage of irrigated land on plat.
Scale: 2" = 1 Mile

STATE OF OREGON }
County of Lane } ss.

I, Bernard A. Kokkela, being first duly sworn, do hereby certify that I have read the foregoing Registration Statement and that all of the items therein contained are true to the best of my knowledge and belief.

Bernard A. Kokkela
(Signature of Registrant)

Subscribed and sworn to before me this 23rd day of May, 1958

My commission expires Feb 17 1960
Reginald J. Pent
(Notary Public)

(SEAL)

CERTIFICATE OF REGISTRATION

STATE OF OREGON }
County of Marion } ss.

This is to certify that the foregoing Registration Statement was received in the office of the State Engineer on the 30th day of July, 1958, at 8:00 o'clock A. M. and has been duly recorded in said office in Book No. 12 of Registration Statements on page QR-2943

Witness my hand this 25th day of May, 1959

1500

Laura A. Stanley
(State Engineer)

By _____
(Deputy)

REGISTERED
10 JULY 1918
STATE DEPT. OF
CIVIL ENGINEERING

Ts 16 S., R 4 W.

RE

S 1/2 of SW 1/4 of NE 1/4 Sec

N

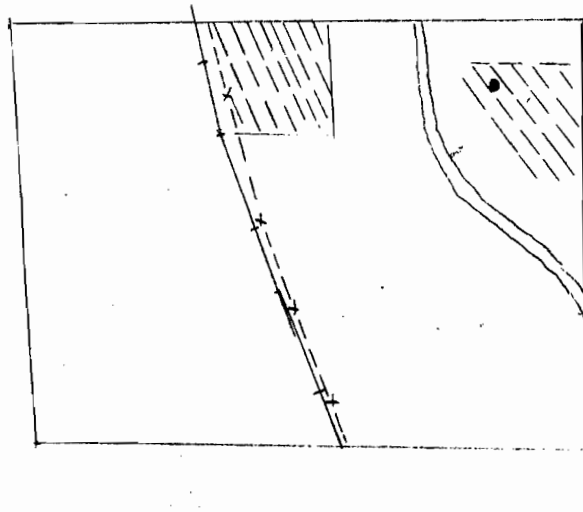

3100' N

1700' W

17	16
20	21

Scale 8" = 1 Mile