

North

SE 1/4 of

SE 1/4

Sec. 19

NE 1/4 of

NE 1/4

Sec. 30

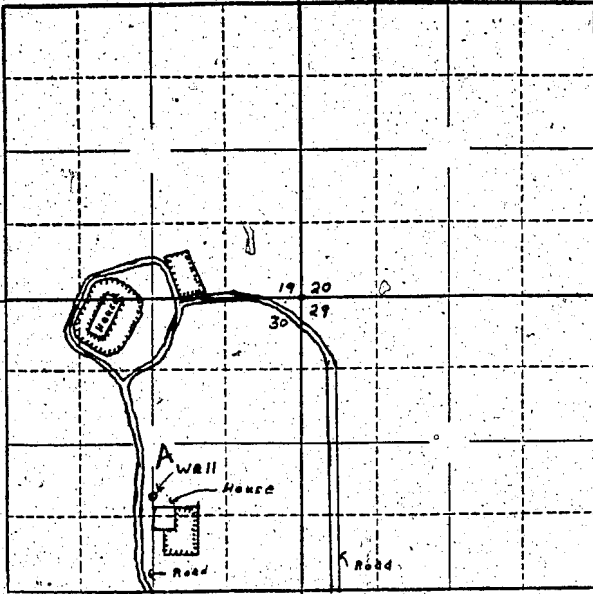

1320 ft. Locate well and acreage of irrigated land on plat.

Scale: ~~1/4~~ 1 Mile Scale: 1" = 400 feet

STATE OF OREGON

County of Jackson

ss.

I, Anna P. Livingston, being first duly sworn, do hereby certify that I have read the foregoing Registration Statement and that all of the items therein contained are true to the best of my knowledge and belief.

Anna P. Livingston (Signature of Registrant)

Subscribed and sworn to before me this 28th day of July, 1958

My commission expires August 15, 1958

(Notary Public)

(SEAL)

CERTIFICATE OF REGISTRATION

STATE OF OREGON

County of Marion

ss.

This is to certify that the foregoing Registration Statement was received in the office of the State Engineer on the 30th day of July, 1958, at 2:30 o'clock A.M. and has been duly recorded in said office in Book No. 13 of Registration Statements on page GR-2972

Witness my hand this 2nd day of June, 1959

Lewis A. Stanley (State Engineer)

By (Deputy)

\$15.00