

Township 85 Range 4W W.M.

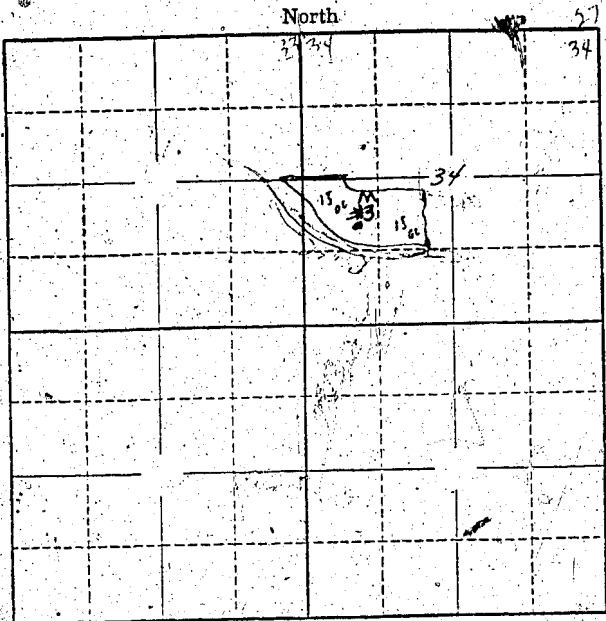

Locate well and acreage of irrigated land on plat.
Scale: 2" = 1 Mile

STATE OF OREGON }
County of Marion } ss.

I, Eugene W. Bennett, being first duly sworn, do hereby certify that I have read the foregoing Registration Statement and that all of the items therein contained are true to the best of my knowledge and belief.

Eugene W. Bennett
(Signature of Registrant)

Subscribed and sworn to before me this 30th day of July, 1958
My Commission expires 12th June 1961 Wm. S. Beathelme
(Notary Public)

(SEAL)

CERTIFICATE OF REGISTRATION

STATE OF OREGON }
County of Marion } ss.

This is to certify that the foregoing Registration Statement was received in the office of the State Engineer on the 30th day of July, 1958, at 4:15 o'clock P. M. and has been duly recorded in said office in Book No. 13 of Registration Statements on page GR-3050

Witness my hand this 8th day of June, 1959

Laura A. Stanley
(State Engineer)

By _____ (Deputy)

#1500

GR - 3050