

North

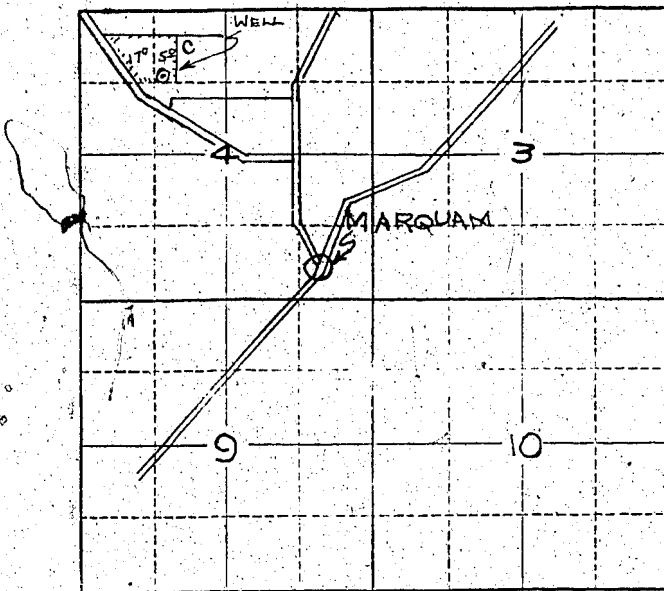

Locate well and acreage of irrigated land on plat.

Scale: 2" = 1 Mile

STATE OF OREGON

County of Marion

ss.

I, [Signature], being first duly sworn, do hereby certify that I have read the foregoing Registration Statement and that all of the items therein contained are true to the best of my knowledge and belief.

JUL 22 1958

(Signature of Registrant)

Subscribed and sworn to before me this 22 day of July, 1958.

My commission expires 4-17-61

(Notary Public)

(SEAL)

CERTIFICATE OF REGISTRATION

STATE OF OREGON

County of Marion

ss.

This is to certify that the foregoing Registration Statement was received in the office of the State Engineer on the 31st day of July, 1958, at 9:30 o'clock A. M. and has been duly recorded in said office in Book No. 13 of Registration Statements on page OR-3066

Witness my hand this 8th day of June, 1959.

[Signature: Lewis A. Stanley]  
(State Engineer)

By \_\_\_\_\_ (Deputy)

\$15.00