

North

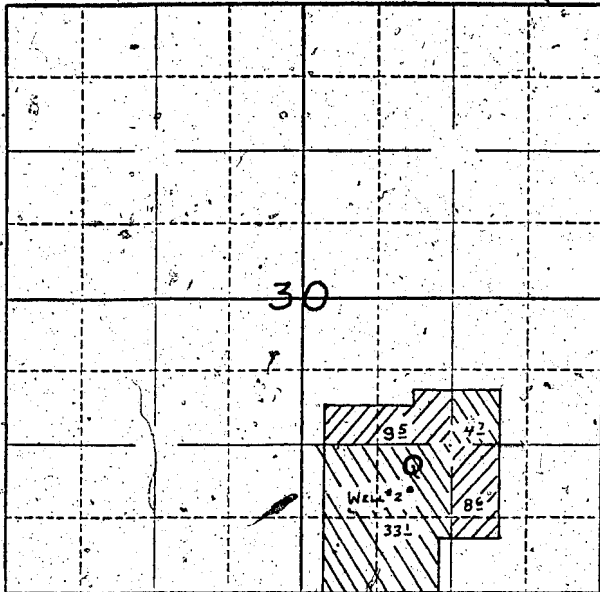

Locate well and acreage of irrigated land on plat.

Scale: $\frac{1}{4}$ " = 1 Mile

STATE OF OREGON

County of Marion } ss.

I, Chester A. Myers, being first duly sworn, do hereby certify that I have read the foregoing Registration Statement and that all of the items therein contained are true to the best of my knowledge and belief.

Chester A. Myers
(Signature of Registrant)

Subscribed and sworn to before me this 30 day of July, 19 58

My commission expires 12-19-58
[Signature]
(Notary Public)

(SEAL)

CERTIFICATE OF REGISTRATION

STATE OF OREGON } ss.
County of Marion

This is to certify that the foregoing Registration Statement was received in the office of the State Engineer on the 31 day of July, 19 58, at 10:30 o'clock A. M. and has been duly recorded in said office in Book No. 16 of Registration Statements on page GR 3795

Witness my hand this 20th day of November, 19 59
[Signature]
(State Engineer)

By _____ (Deputy)

\$18.90