

Township 6 N Range 35 E W.M.

North

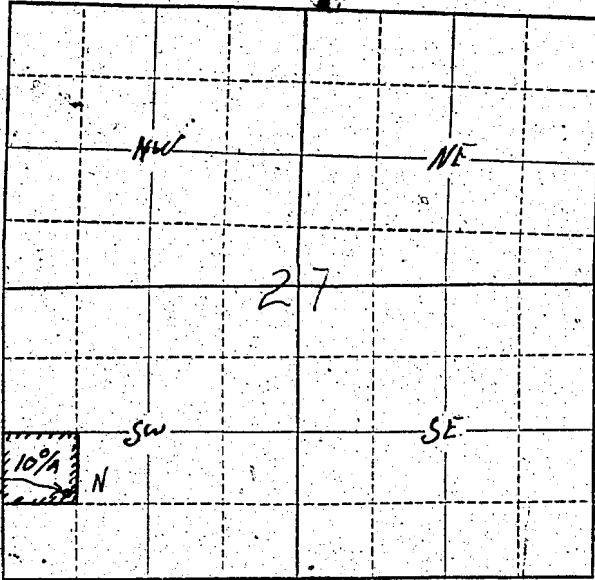

Well Location
 710 feet North
 & 610 feet East
 of SW Corner
 of Section 27

Locate well and acreage of irrigated land on plat.

Scale: $\frac{2}{4}'' = 1 \text{ Mile}$

STATE OF OREGON

County of Umatilla } ss.

I, Clifford C. Karker, being first duly sworn, do hereby certify that I have read the foregoing Registration Statement and that all of the items therein contained are true to the best of my knowledge and belief.

Clifford C. Karker
 (Signature of Registrant)

Subscribed and sworn to before me this 29th day of July, 1958

My commission expires October 6th, 1960

B. K. [Signature]
 (Notary Public) for Oregon

(SEAL)

CERTIFICATE OF REGISTRATION

STATE OF OREGON

County of Marion } ss.

This is to certify that the foregoing Registration Statement was received in the office of the State Engineer on the 31st day of July, 1958, at 2:00 o'clock A. M. and has been duly recorded in said office in Book No. 13 of Registration Statements on page GR 3101

Witness my hand this 16th day of June, 1959

Luvis A. Stanley
 (State Engineer)

By _____
 (Deputy)

#15.00

GR - 3101