

Sec 35 Township 6 S Range 2 W W.M.  
North

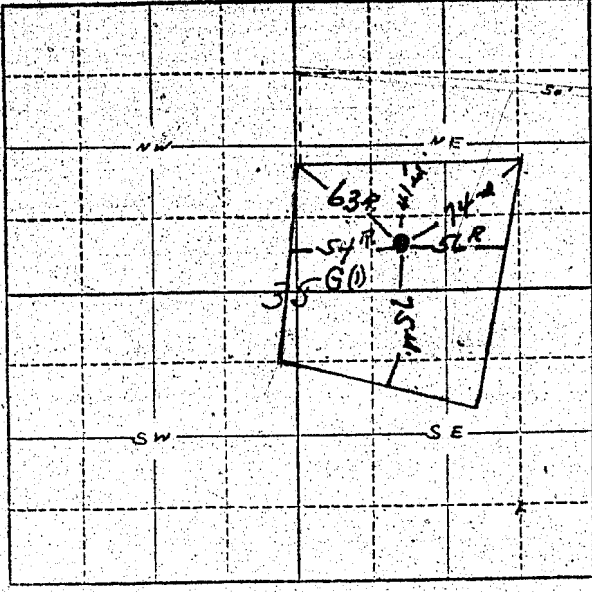

Locate well and acreage of irrigated land on plat.  
Scale: 2" = 1 Mile

STATE OF OREGON

County of Marion } ss.

I, Edward E. Lillian Hynes, being first duly sworn, do hereby certify that I have read the foregoing Registration Statement and that all of the items therein contained are true to the best of my knowledge and belief.

Edward Hynes and Lillian Hynes  
by Edward Hynes (Signature of Registrant)

Subscribed and sworn to before me this 17<sup>th</sup> day of January, 1957.

My commission expires Sept. 8, 1960 Chris A. Shelton (Notary Public)

(SEAL)

**CERTIFICATE OF REGISTRATION**

STATE OF OREGON }  
County of Marion } ss.

This is to certify that the foregoing Registration Statement was received in the office of the State Engineer on the 17<sup>th</sup> day of January, 1957, at 10:00 o'clock A. M. and has been duly recorded in said office in Book No. 2 of Registration Statements on page GR-323 C.

~~Construction shall be completed by X-X-X-X-X-X-X-X-X-X-19-X-X, and the water completely applied to the fields by X-X-X-X-X-X-X-X-X-X-19-X-X.~~

Witness my hand this 1st day of April, 1957.

Lewis A. Stanley  
(State Engineer)

\$22.50

By \_\_\_\_\_ (Deputy)

GR-323 C  
323