

North

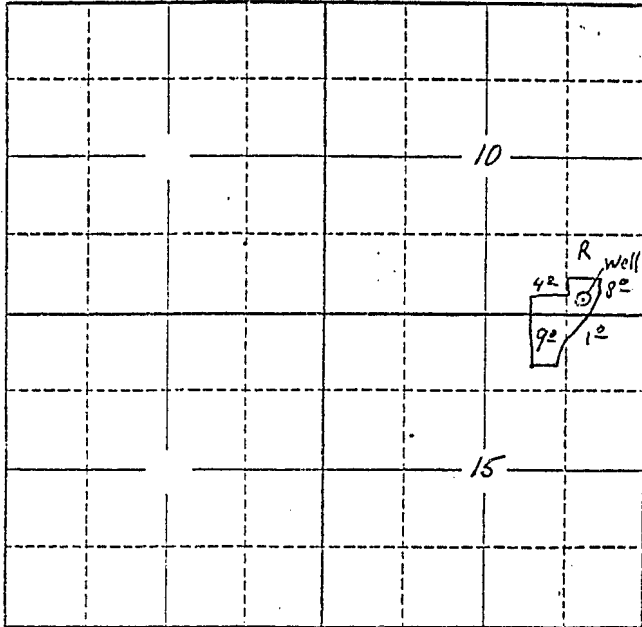

Locate well and acreage of irrigated land on plat.

Scale: 2" = 1 Mile

STATE OF OREGON

County of _____ } ss.

I, Harold Wallander, being first duly sworn, do hereby certify that I have read the foregoing Registration Statement and that all of the items therein contained are true to the best of my knowledge and belief.

Harold Wallander
(Signature of Registrant)

Subscribed and sworn to before me this 10th day of June, 1966

My commission expires Nov 3, 1968

Samuel J. [Signature]
(Notary Public)

(SEAL)

CERTIFICATE OF REGISTRATION

This statement filed in lieu of original statement lost.

STATE OF OREGON

County of Marion } ss.

This is to certify that the foregoing Registration Statement was received in the office of the State Engineer on the 10th day of June, 1966, at 1:50 o'clock P. M. and has been duly recorded in said office in Book No. 17 of Registration Statements on page GR-4155

Witness my hand this 5th day of August, 1966

[Signature]
(State Engineer)

By _____
(Deputy)

\$15.00