

Township 14 S Range 3 W, W.M.

North

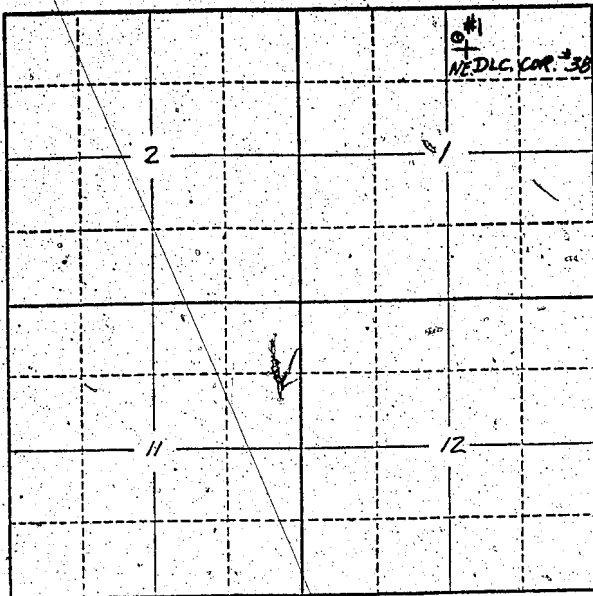

Locate well and acreage of irrigated land on plat.

Scale: 2" = 1 Mile

STATE OF OREGON

County of \_\_\_\_\_

} ss.

I, \_\_\_\_\_, being first duly sworn, do hereby certify that I have read the foregoing Registration Statement and that all of the items therein contained are true to the best of my knowledge and belief.

Lewis A. Stanley  
(Signature of Registrant)

Subscribed and sworn to before me this 30<sup>th</sup> day of June, 1960.

My commission expires \_\_\_\_\_

(Notary Public)

(SEAL)

### CERTIFICATE OF REGISTRATION

STATE OF OREGON

County of Marion

} ss.

This is to certify that the foregoing Registration Statement was received in the office of the State Engineer on the 31<sup>st</sup> day of July, 1959, at 1:00 o'clock P. M. and has been duly recorded in said office in Book No. 17 of Registration Statements on page GR 4091

Witness my hand this 17<sup>th</sup> day of June, 1960.

Lewis A. Stanley  
(State Engineer)

By \_\_\_\_\_  
(Deputy)

# 20.00