

**HYDRAULIC PROFILE**  
 SCALE: HORIZ: NONE  
 VERT: 1" = 5'

FACILITY/STRUCTURE	DESIGN CAPACITY	APPROX. WATER EL. AT FACILITY CAPACITY
EXISTING MIDDLE INTAKE	147 MGD (227 CFS)	479.0 (MIN)
EXISTING FILTER (4 EAST & 4 WEST)	21 MGD EACH	476.50
EXISTING FILTER (3 EAST & 3 WEST)	21 MGD EACH	476.00
NEW RECONSTRUCTED FILTER (1 EAST & 1 WEST) (SCHEDULE A)	21 MGD EACH	475.75
FUTURE RECONSTRUCTED FILTER (2 EAST & 2 WEST) (SCHEDULE B)	21 MGD EACH	475.25
PIPELINES AT CHLORINE INJECTION PT. NEAR - W. END OF ISLAND	147 MGD COMBINED	459.0*

NOTE: THIS SHEET ONLY. ALL FACILITIES ARE EXISTING UNLESS OTHERWISE NOTED.

**799037**

WARNING  
 3/4" = 1"  
 IF THIS BAR DOES NOT MEASURE 1" THEN DRAWING IS NOT TO SCALE

RECEIVED  
 DEC 17 2013  
 OUSD

CONFORMING TO CONSTRUCTION RECORDS

CITY OF SALEM  
 PUBLIC WORKS DEPARTMENT  
 GEREN ISLAND TREATMENT FACILITY IMPROVEMENTS AND PUMP STATION  
 HYDRAULIC PROFILE

CHWD: RJK  
 APPR: RJK  
 FILE NO.: 799037-33.DWG  
 SHEET 33 OF 76

THIS DRAWING WAS ORIGINALLY SEALED BY RANDALL J. KRUEGER, A REGISTERED PROFESSIONAL ENGINEER IN THE STATE OF OREGON NO. 15639

REVISIONS

NO	DESCRIPTION	DATE	BY	REASON
1	CONFORMING TO CONSTRUCTION RECORDS	06/03	DEC	FILE
2	REV. ACKNOWLEDGMENT AND SIGNATURES ON COVER SHEET (SHEET 1)			

DATUM: N/A  
 SURVEY: N/A  
 HORIZ. SCALE: AS SHOWN  
 VERT. SCALE: AS SHOWN  
 DESIGN: JFD  
 BRANTY: VEC

This drawing was originally signed by the indicated City of Salem staff.

CITY OF SALEM  
 REVIEWED BY: S. OLDS 04/22/01  
 APPROVED BY: KEITH WINSORHANT 04/22/01



B & V PROJECT NO: 28495 0307

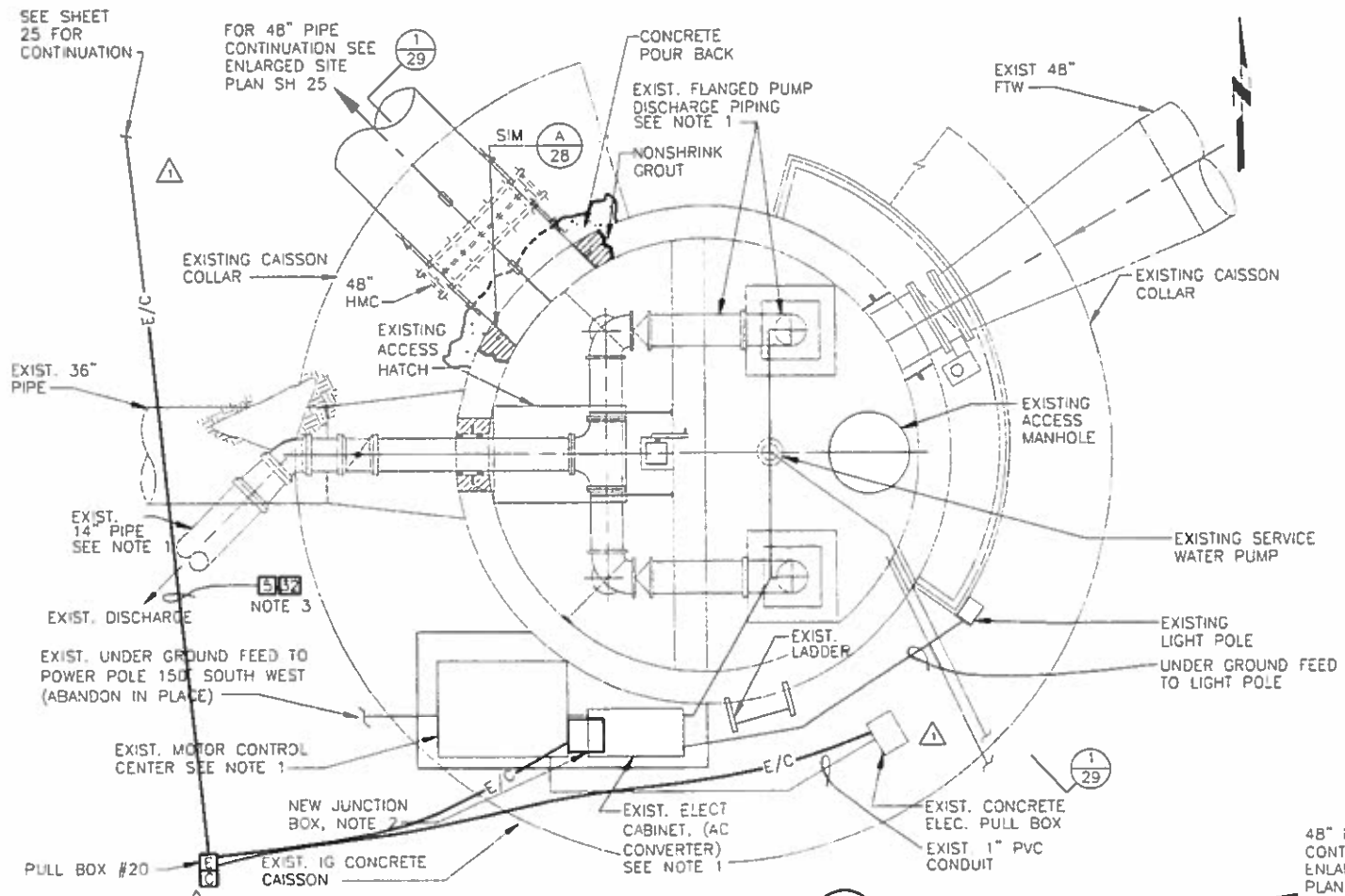

**PLAN - EXISTING IG CAISSON**  
SCALE: 3/8" = 1'-0"

- NOTES:
1. REMOVE AND DISPOSE OF VERT PUMPS/MOTORS, MCC AND MISC. ELEC. EQUIPMENT AND ALL DISCHARGE PIPING & VALVES. CAP 14" PIPE AT EXISTING 42" FTW/FW PIPE CONNECTION. CAP ALL ELECTRICAL CONDUITS AT GRADE AFTER REMOVAL OF EQUIPMENT. PROVIDE AN ALUMINUM CHECKERED PLATE COVER OVER EXIST PUMP PADS.
  2. PROVIDE NEW NEMA 4 JUNCTION BOX. J-BOX SHALL BE LOCATED ON TOP OF EXISTING FILTER 3, FILTER 4 AND SERVICE WATER PUMP CONDUITS AFTER THE MCC HAS BEEN REMOVE. J-BOX SHALL BE USED TO PULL EXISTING FILTER 3 & 4, COILED WIRES BACK TO NEW MCC-B IN PUMP STATION. J-BOX SHALL ALSO BE USED TO SPLICE NEW AND EXISTING WIRES FOR SERVICE WATER PUMP AND INSTRUMENTATION.
  3. CIRCUIT NO. DESIGNATED BY NO. SEE SHEET 68 FOR CIRCUIT SCHEDULE.

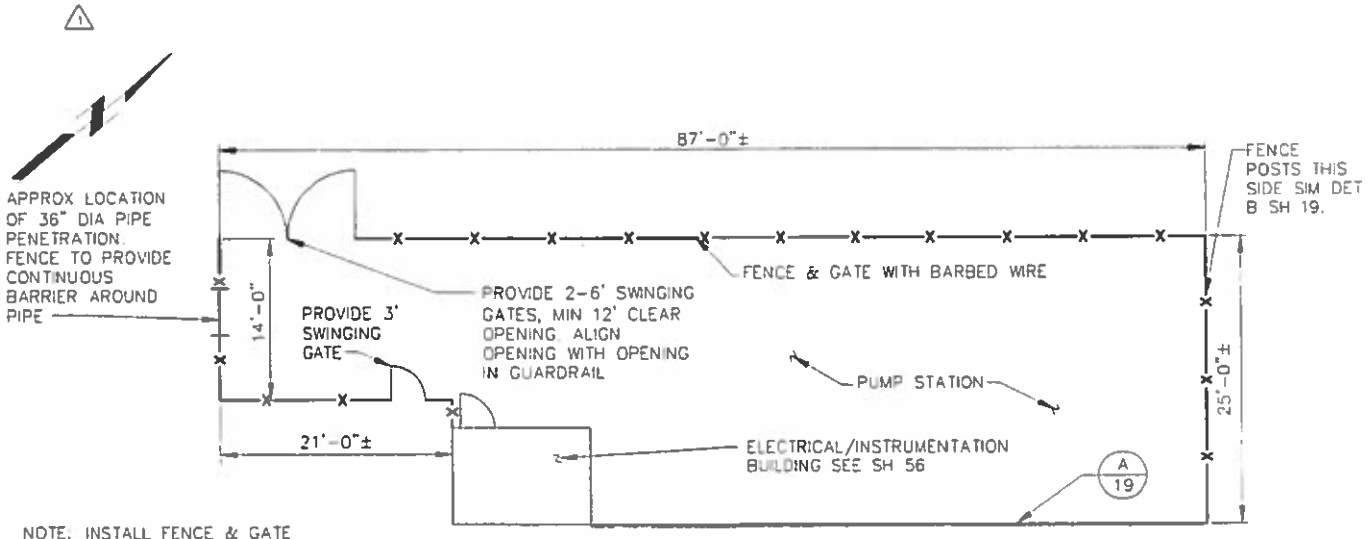

**FENCING SITE PLAN, PUMP STATION**  
SCALE: 1/8" = 1'

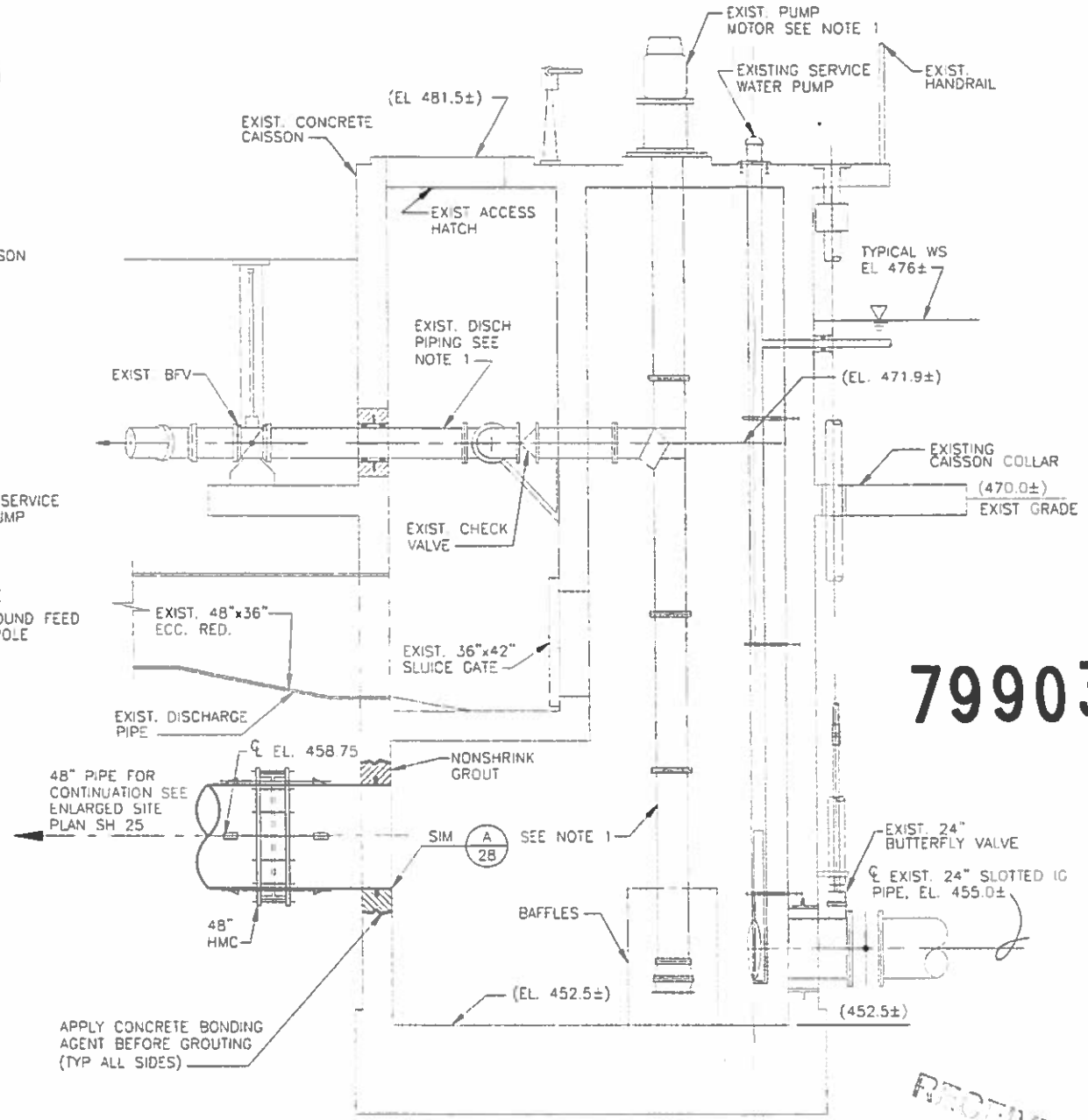

**SECTION 1**  
SCALE: 3/8" = 1'-0"

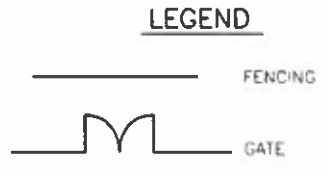

NOTE: INSTALL FENCE AND GATE WITH BARBED WIRE TO NEW FILTER NO. 1 AND FILTER NO. 2 CONTROL STRUCTURES.

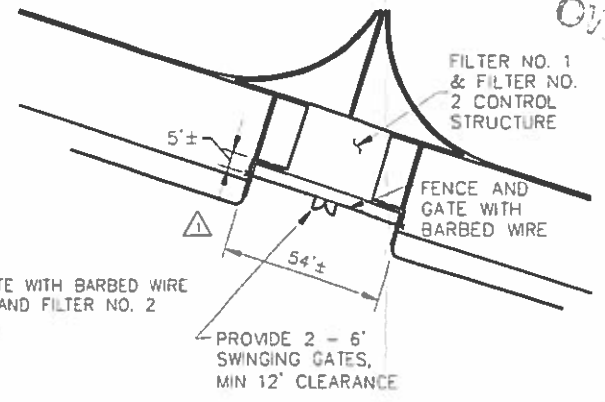

**FENCING SITE PLAN, FILTERS 1 & 2**  
SCALE: 1" = 20'

**799037**

This drawing was originally signed by the indicated City of Salem staff.

CITY OF SALEM  
REVIEWED BY: S. OLES 04/27/01  
APPROVED BY: KEITH WASHINGTON 04/27/01



CONFORMING TO CONSTRUCTION RECORDS

THIS DRAWING WAS ORIGINALLY SEALED BY RANDALL J. KRUEGER, A REGISTERED PROFESSIONAL ENGINEER IN THE STATE OF OREGON NO. 15639

NO.	DESCRIPTION	DATE	BY	APP.
1	LAST AND BEST ACCESS RAMP	12-01	DAVID J. J.	
2	CLOSED FOR FILTER	04/01	DAVID J. J.	
3	CONFORMANCE TO CONSTRUCTION RECORDS	04/01	DAVID J. J.	
4	SEE WORKSHEET AND DRAWING			
5	ON SHEET 29 (SHEET 1)			

CITY OF SALEM	PUBLIC WORKS DEPARTMENT	CHECKED	DATE
GREEN ISLAND TREATMENT FACILITY IMPROVEMENTS AND PUMP STATION	SLOW SAND FILTERS AND PUMP STATION	R.K.	04/27/01
EXISTING IG CAISSON AND SECURITY FENCING		R.K.	04/27/01
FILE NO. 799037-29.DWG			
SHEET 29 OF 76			



WARNING  
IF THIS BAR DOES NOT MEASURE 1" THEN DRAWING IS NOT TO SCALE

B & V PROJECT NO: 28495-0307-16

R 4W

R 3W

R 2W

R 1W

R 1E

T 6S

T 7S

T 8S

T 9S

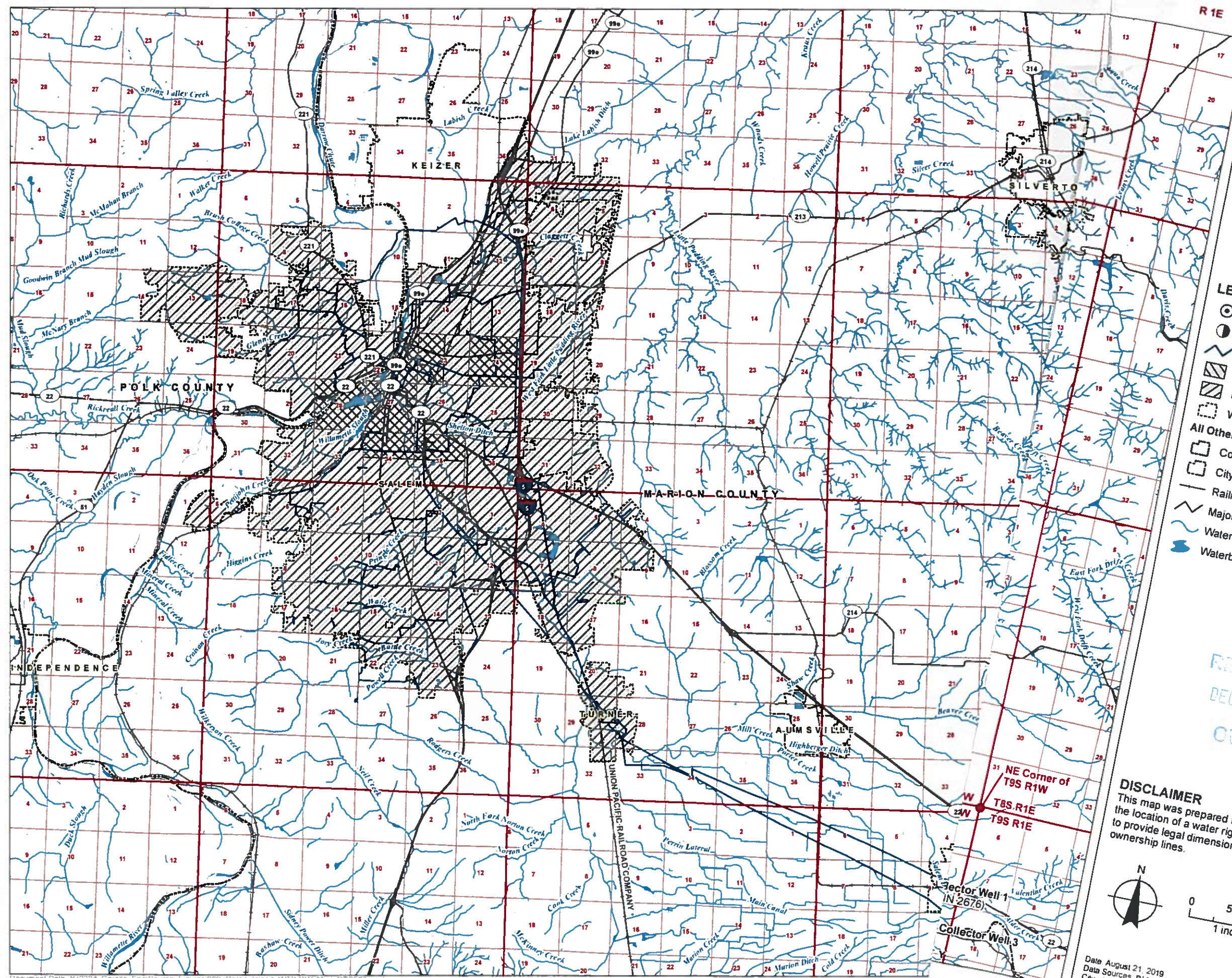

**Application for a Groundwater  
Registration Modification  
(GR-3507)**  
A Water Right in the  
Name of City of Salem  
Place of Use Map  
Marion and Polk County, Oregon

**LEGEND**

- ⊙ Authorized Point of Appropriation (POA)
- Proposed Point of Appropriation (POA)
- Water Main Line
- ▨ Authorized Place of Use (POU)
- ▩ Proposed Place of Use (POU)
- Water Service Area
- All Other Features
- County Boundary
- City Boundary
- Railroad
- Major Road
- ~ Watercourse
- Waterbody

13316

RECEIVED  
DEC 17 2019  
OWRD

**DISCLAIMER**  
This map was prepared for the purpose of identifying  
the location of a water right only and it is not intended  
to provide legal dimensions or location of property  
ownership lines.

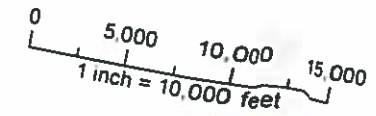

Date August 21, 2019  
Data Sources BLM, USGS, ESRI, OWRD  
City of Salem, Marion Co



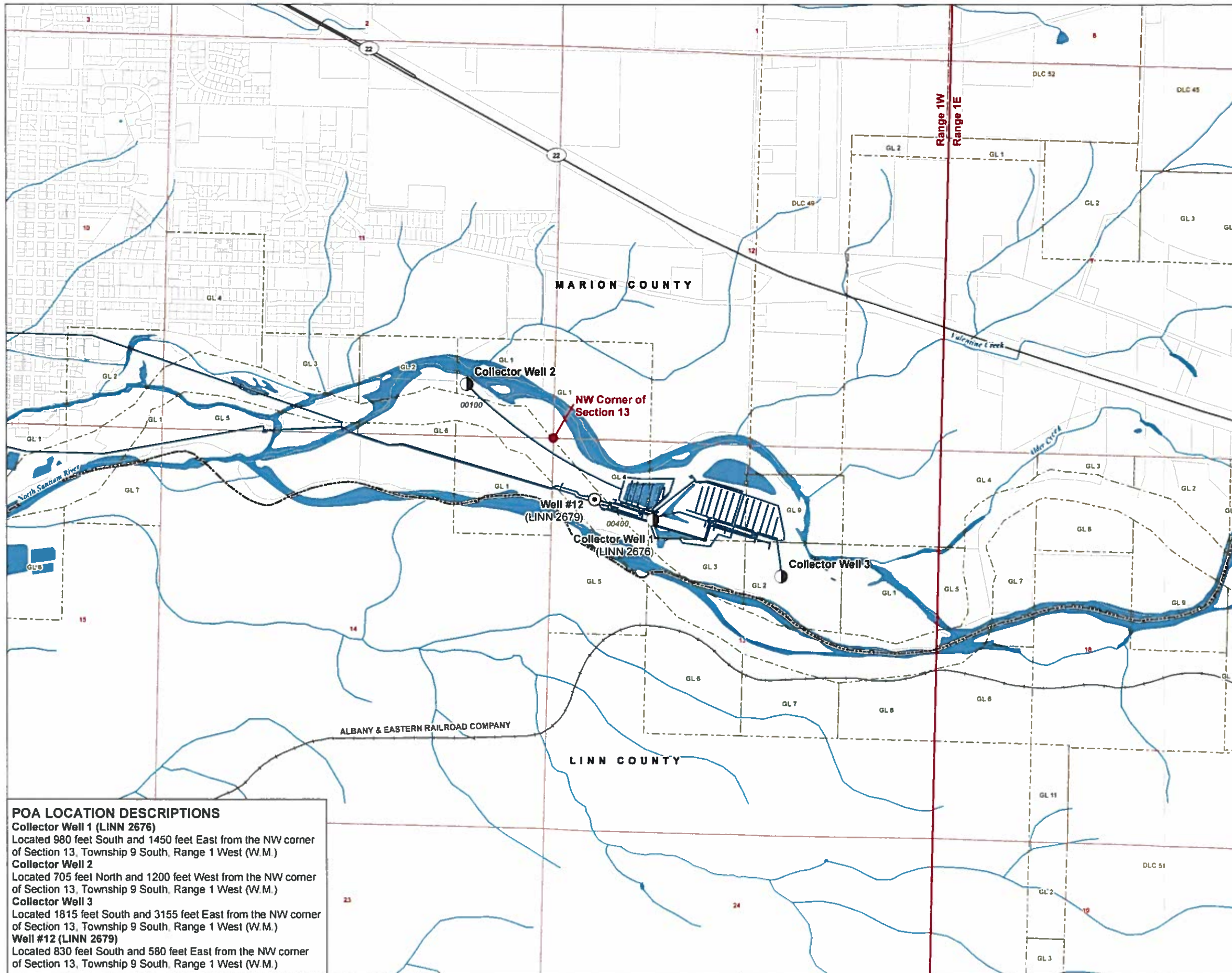

**Application for a Groundwater  
Registration Modification  
(GR-3507)**

**A Water Right in the  
Name of City of Salem  
Point of Appropriation Map**

**Marion County, Oregon  
Township 9 South,  
Range 1 West (W.M.)**

**LEGEND**

- ⊙ Authorized Point of Appropriation (POA)
- Proposed Point of Appropriation (POA)
- Water Main Line
- ▭ Donation Land Claim (DLC)
- ▭ Government Lot (GL)
- All Other Features**
- ▭ County Boundary
- ⊕ Tax Lot
- Railroad
- Major Road
- ~ Watercourse
- Waterbody

RECEIVED  
DEC 17 2019  
OWRD

**DISCLAIMER**

This map was prepared for the purpose of identifying the location of a water right only and it is not intended to provide legal dimensions or location of property ownership lines.

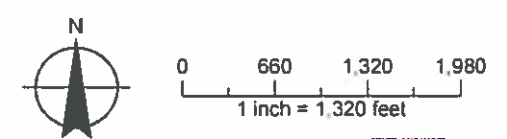

**POA LOCATION DESCRIPTIONS**  
**Collector Well 1 (LINN 2676)**  
 Located 980 feet South and 1450 feet East from the NW corner of Section 13, Township 9 South, Range 1 West (W.M.)  
**Collector Well 2**  
 Located 705 feet North and 1200 feet West from the NW corner of Section 13, Township 9 South, Range 1 West (W.M.)  
**Collector Well 3**  
 Located 1815 feet South and 3155 feet East from the NW corner of Section 13, Township 9 South, Range 1 West (W.M.)  
**Well #12 (LINN 2679)**  
 Located 830 feet South and 580 feet East from the NW corner of Section 13, Township 9 South, Range 1 West (W.M.)

13316-



**Application for a Groundwater  
Registration Modification  
(GR-3510)**

**A Water Right in the  
Name of City of Salem  
Point of Appropriation Map**

**Marion County, Oregon  
Township 9 South,  
Range 1 West (W.M.)**

**LEGEND**

- ⊙ Authorized Point of Appropriation (POA)
- Proposed Point of Appropriation (POA)
- Water Main Line
- ⊞ Donation Land Claim (DLC)
- ⊞ Government Lot (GL)
- All Other Features**
- ▭ County Boundary
- ▭ Tax Lot
- Railroad
- Major Road
- ~ Watercourse
- Waterbody

RECEIVED  
DEC 17 2019  
CITY OF SALEM

**DISCLAIMER**

This map was prepared for the purpose of identifying the location of a water right only and it is not intended to provide legal dimensions or location of property ownership lines.



0 660 1,320 1,980  
1 inch = 1,320 feet

Date: September 5, 2019  
Data Sources: BLM, USGS, ESRI, OWRD,  
City of Salem, Marion Co

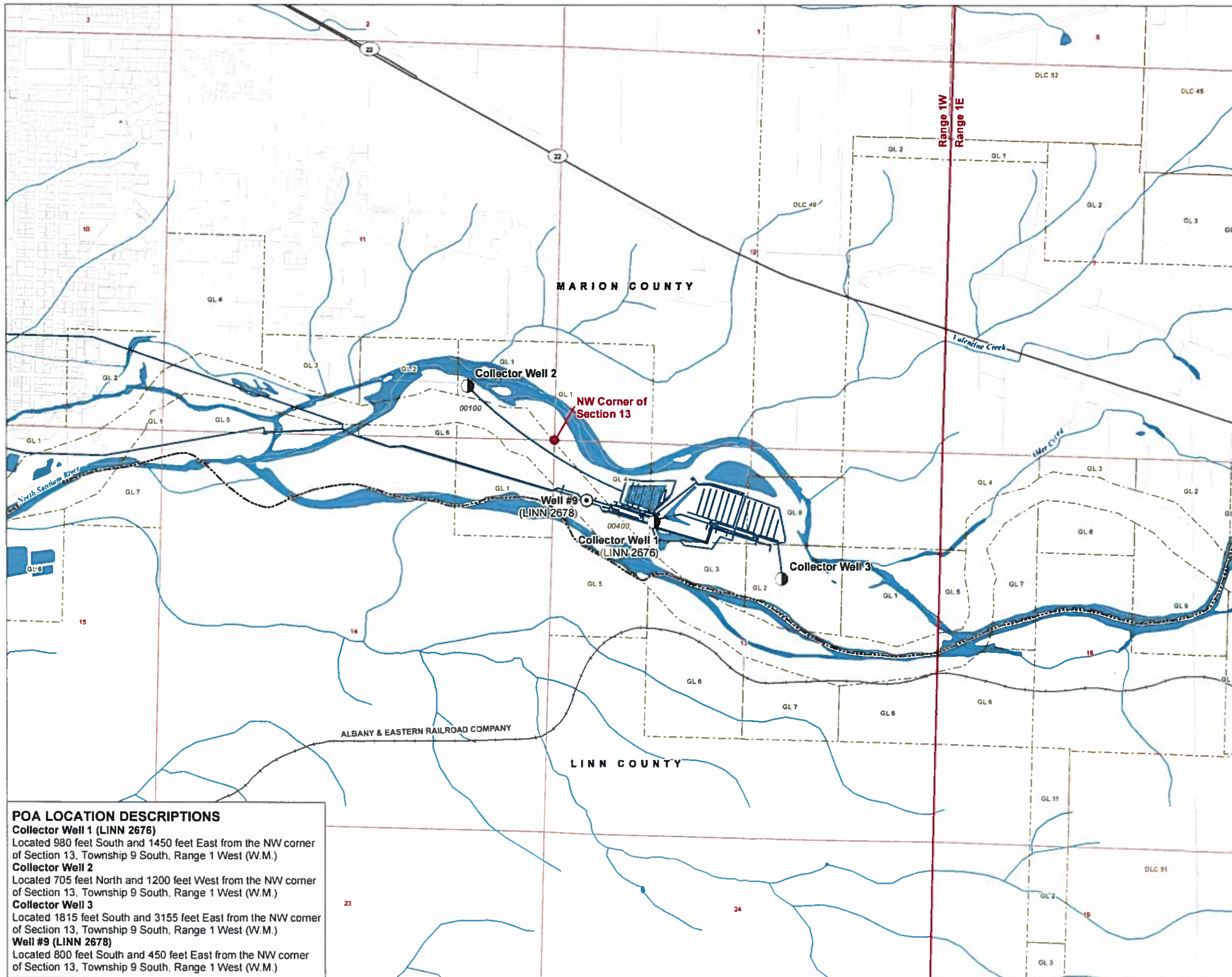

**POA LOCATION DESCRIPTIONS**  
**Collector Well 1 (LINN 2676)**  
 Located 980 feet South and 1450 feet East from the NW corner of Section 13, Township 9 South, Range 1 West (W.M.)  
**Collector Well 2**  
 Located 705 feet North and 1200 feet West from the NW corner of Section 13, Township 9 South, Range 1 West (W.M.)  
**Collector Well 3**  
 Located 1815 feet South and 3155 feet East from the NW corner of Section 13, Township 9 South, Range 1 West (W.M.)  
**Well #9 (LINN 2678)**  
 Located 800 feet South and 450 feet East from the NW corner of Section 13, Township 9 South, Range 1 West (W.M.)

13316-

R 4W

R 3W

R 1E

T 6S

T 7S

T 8S

T 9S

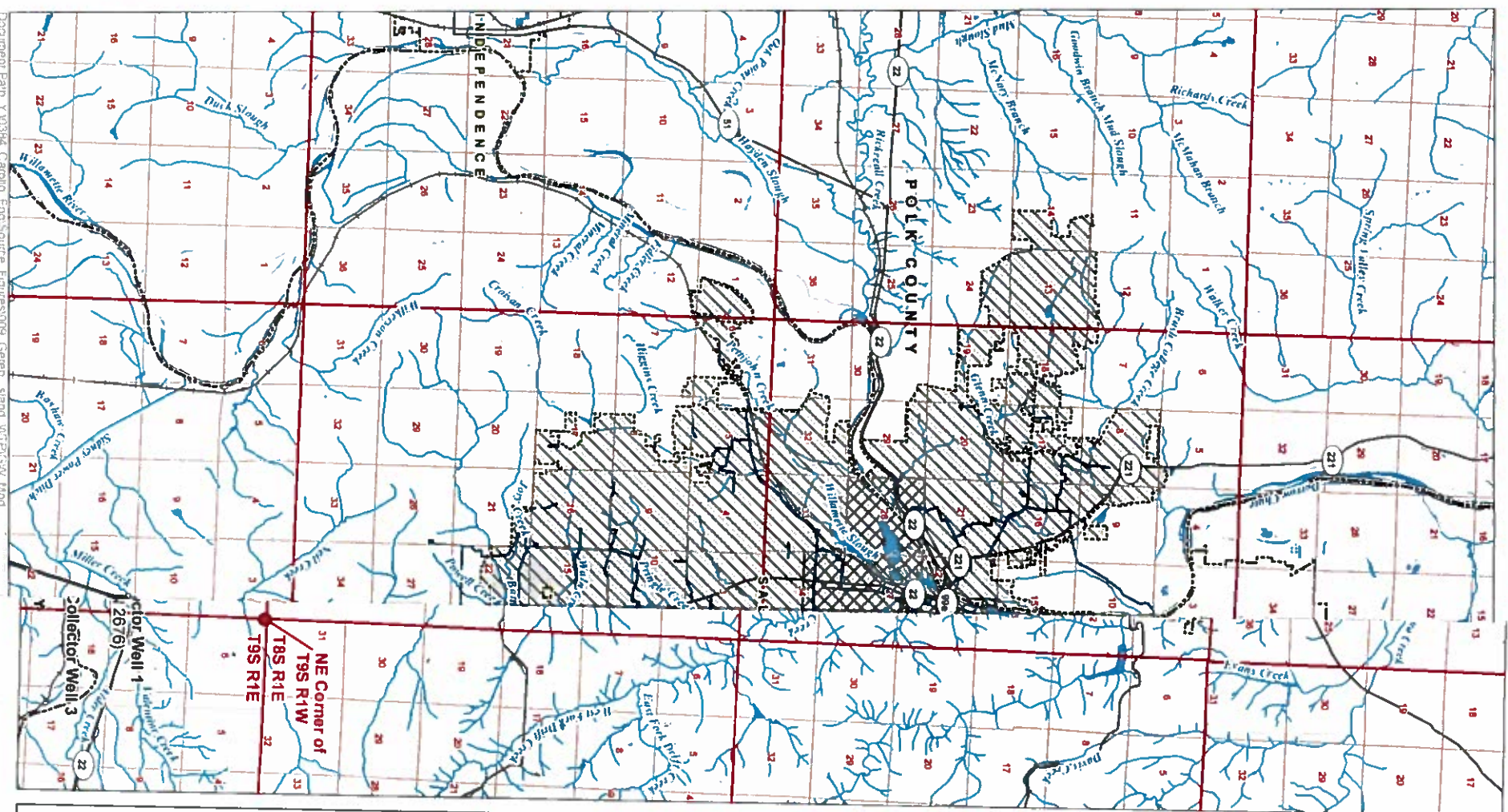

**Application for a Groundwater  
Registration Modification  
(GR-3510)**

**A Water Right in the  
Name of City of Salem  
Place of Use Map**

**Marion and Polk County, Oregon**

**LEGEND**

- Authorized Point of Appropriation (POA)
- Proposed Point of Appropriation (POA)
- Water Main Line
- ▨ Authorized Place of Use (POU)
- ▩ Proposed Place of Use (POU)
- ▧ Water Service Area
- ▭ All Other Features
- ▭ County Boundary
- ▭ City Boundary
- Railroad
- Major Road
- Watercourse
- Waterbody

RECEIVED  
DEC 2 2013  
CITY OF SALEM

**DISCLAIMER**

This map was prepared for the purpose of identifying the location of a water right only and it is not intended to provide legal dimensions or location of property ownership lines.

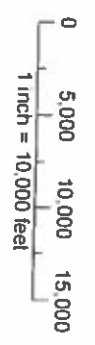

Date: October 10, 2019  
Data Sources: BLM, USGS, ESRI, OWRD  
City of Salem, Marion Co



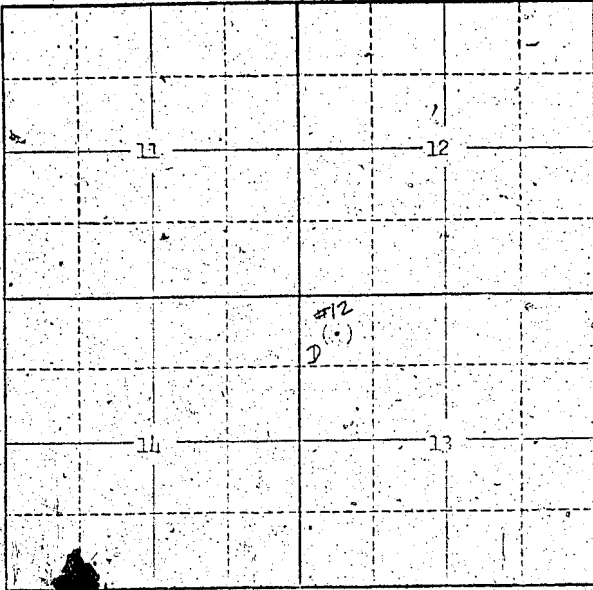

Locate well and acreage of irrigated land on plat.  
Scale: 2" = 1 Mile

STATE OF OREGON

County of MASTON

ss.

I, JOHN L. DEAN, being first duly sworn, do hereby certify that I have read the foregoing Registration Statement and that all of the items therein contained are true to the best of my knowledge and belief.

*John L. Dean*  
(Signature of Registrar)

Subscribed and sworn to before me this 20 day of July, 1959

My commission expires July 1, 1961

(Notary Public)

(SEAL)

**CERTIFICATE OF REGISTRATION**

STATE OF OREGON

County of Marion

ss.

This is to certify that the foregoing Registration Statement was received in the office of the State Engineer on the 21st day of July, 1959 at 9:00 o'clock A.M. and has been duly recorded in said office in Book No. 13 of Registration Statements on page GR 3227

Witness my hand this 20th day of July, 1959

(State Engineer)

By \_\_\_\_\_ (Deputy)

\$26.00