

North

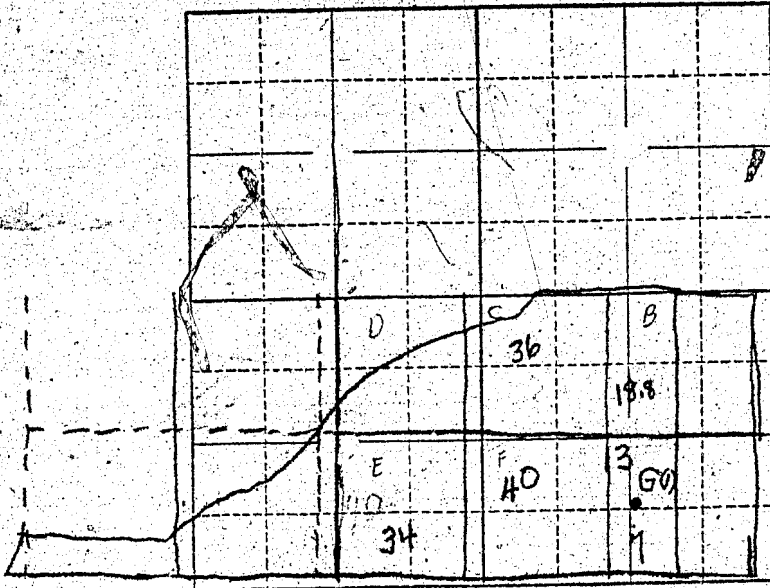

See final proof map in application 17809

Locate well and acreage of irrigated land on plat.

Scale: $\frac{1}{4}$ " = 1 Mile

STATE OF OREGON

County of Folk

ss.

I, Pearl Ruddell, being first duly sworn, do hereby certify that I have read the foregoing Registration Statement and that all of the items therein contained are true to the best of my knowledge and belief.

Pearl Ruddell
(Signature of Registrant)

Subscribed and sworn to before me this 29th day of January, 1957

My commission expires _____ NOTARY PUBLIC FOR OREGON My Commission Expires Jan. 27, 1959

Beulah L. Fisher
(Notary Public)

(SEAL)

CERTIFICATE OF REGISTRATION

STATE OF OREGON

County of Marion

ss.

This is to certify that the foregoing Registration Statement was received in the office of the State Engineer on the 30th day of January, 1957 at 8:00 o'clock A.M. and has been duly recorded in said office in Book No. 2 of Registration Statements on page GR-337 C

~~Construction shall be completed by X-X-X-X-X-X-X-X-X-X-X-X-X-X and the water completely applied to beneficial use by X-X-X-X-X-X-X-X-X-X-X-X-X-X~~

Witness my hand this 1st day of April, 1957

Lewis A. Stanley
(State Engineer)

#27.95

By _____ (Deputy)