

HYDRAULIC PROFILE
SCALE: HORIZ: NONE
VERT: 1" = 5'

FACILITY/STRUCTURE	DESIGN CAPACITY	APPROX. WATER EL. AT FACILITY CAPACITY
EXISTING MIDDLE INTAKE	147 MGD (227 CFS)	479.0 (MIN)
EXISTING FILTER (4 EAST & 4 WEST)	21 MGD EACH	476.50
EXISTING FILTER (3 EAST & 3 WEST)	21 MGD EACH	476.00
NEW RECONSTRUCTED FILTER (1 EAST & 1 WEST) (SCHEDULE A)	21 MGD EACH	475.75
FUTURE RECONSTRUCTED FILTER (2 EAST & 2 WEST) (SCHEDULE B)	21 MGD EACH	475.25
PIPELINES AT CHLORINE INJECTION PT. NEAR - W. END OF ISLAND	147 MGD COMBINED	459.0*

NOTE: THIS SHEET ONLY. ALL FACILITIES ARE EXISTING UNLESS OTHERWISE NOTED.

799037



IF THIS BAR DOES NOT MEASURE 1" THEN DRAWING IS NOT TO SCALE

CONFORMING TO CONSTRUCTION RECORDS

CITY OF SALEM
PUBLIC WORKS DEPARTMENT
GEREN ISLAND TREATMENT FACILITY IMPROVEMENTS AND PUMP STATION
SLOW SAND FILTER NO. 1 RECONSTRUCTION AND PUMP STATION
HYDRAULIC PROFILE

DATE: 12/17/2019
DRAWN: RJK
CHECKED: RJK
APPROVED: RJK

NO. 1
DESCRIPTION: CONSTRUCTION RECORDS
DATE: 12/17/2019
BY: RJK
SCALE: AS SHOWN
SHEET: 33 OF 76

REVISIONS:

NO.	DESCRIPTION	DATE	BY
1	CONFORMING TO CONSTRUCTION RECORDS	12/17/2019	RJK

DATE: N/A
SCALE: AS SHOWN
SHEET: 33 OF 76

THIS DRAWING WAS ORIGINALLY SEALED BY RANDALL J. KRUEGER, A REGISTERED PROFESSIONAL ENGINEER IN THE STATE OF OREGON NO. 15639

This drawing was originally signed by the indicated City of Salem staff

CITY OF SALEM
REVIEWED BY: S. OLOS 04/27/01
APPROVED BY: KEITH WIMSDAUNT 04/27/01



B & V PROJECT NO: 28495 0307

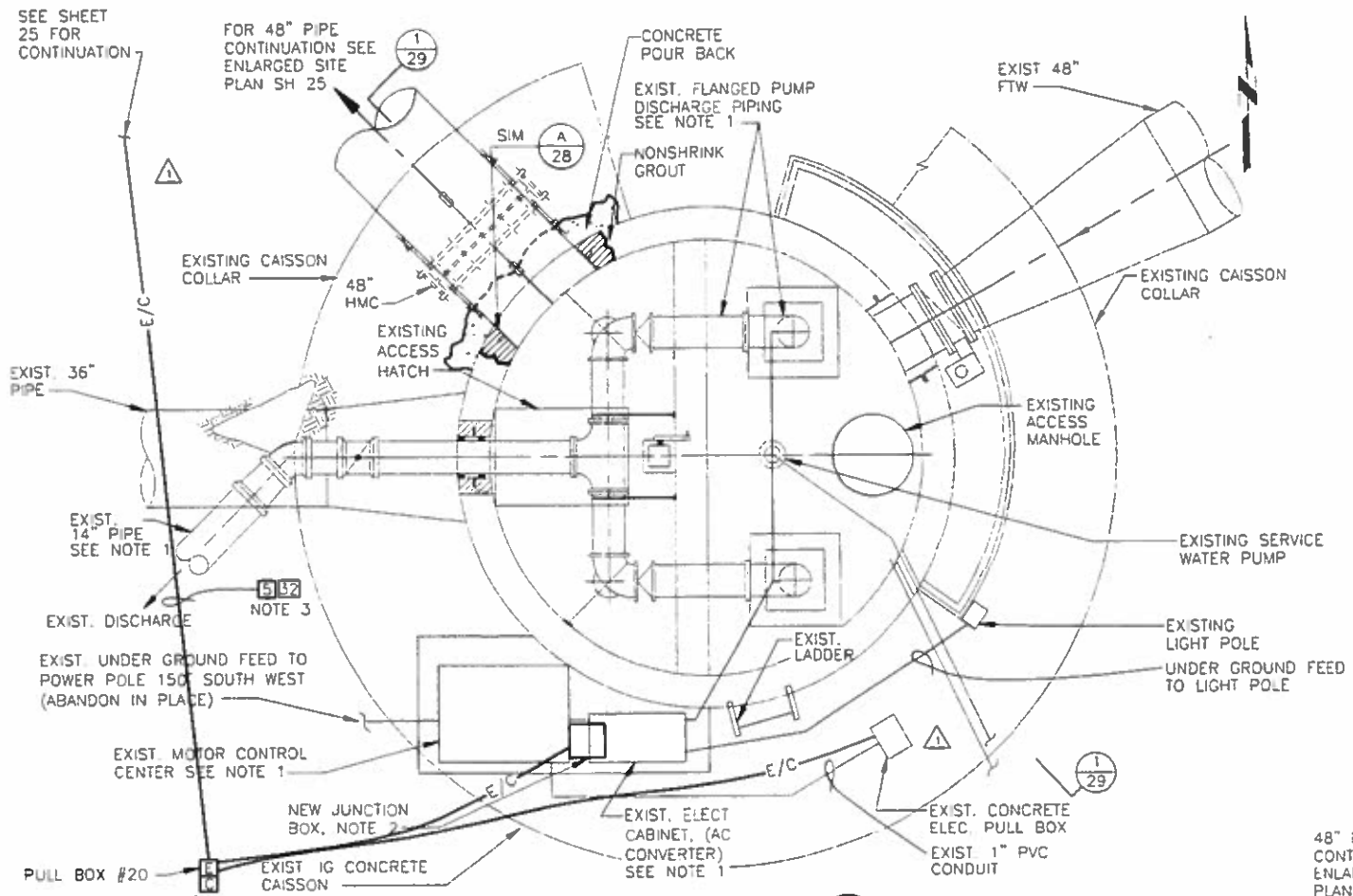

PLAN - EXISTING IG CAISSON
SCALE: 3/8" = 1'-0"

- NOTES:**
1. REMOVE AND DISPOSE OF VERT. PUMPS/MOTORS, MCC AND MISC. ELEC. EQUIPMENT AND ALL DISCHARGE PIPING & VALVES CAP 14" PIPE AT EXISTING 42" FTW/FW PIPE CONNECTION. CAP ALL ELECTRICAL CONDUITS AT GRADE AFTER REMOVAL OF EQUIPMENT. PROVIDE AN ALUMINUM CHECKERED PLATE COVER OVER EXIST PUMP PADS.
 2. PROVIDE NEW NEMA 4 JUNCTION BOX. J-BOX SHALL BE LOCATED ON TOP OF EXISTING FILTER 3, FILTER 4 AND SERVICE WATER PUMP CONDUITS AFTER THE MCC HAS BEEN REMOVED. J-BOX SHALL BE USED TO PULL EXISTING FILTER 3 & 4, COILED WIRES BACK TO NEW MCC-B IN PUMP STATION. J-BOX SHALL ALSO BE USED TO SPLICE NEW AND EXISTING WIRES FOR SERVICE WATER PUMP AND INSTRUMENTATION.
 3. CIRCUIT NO. DESIGNATED BY NO. SEE SHEET 68 FOR CIRCUIT SCHEDULE.

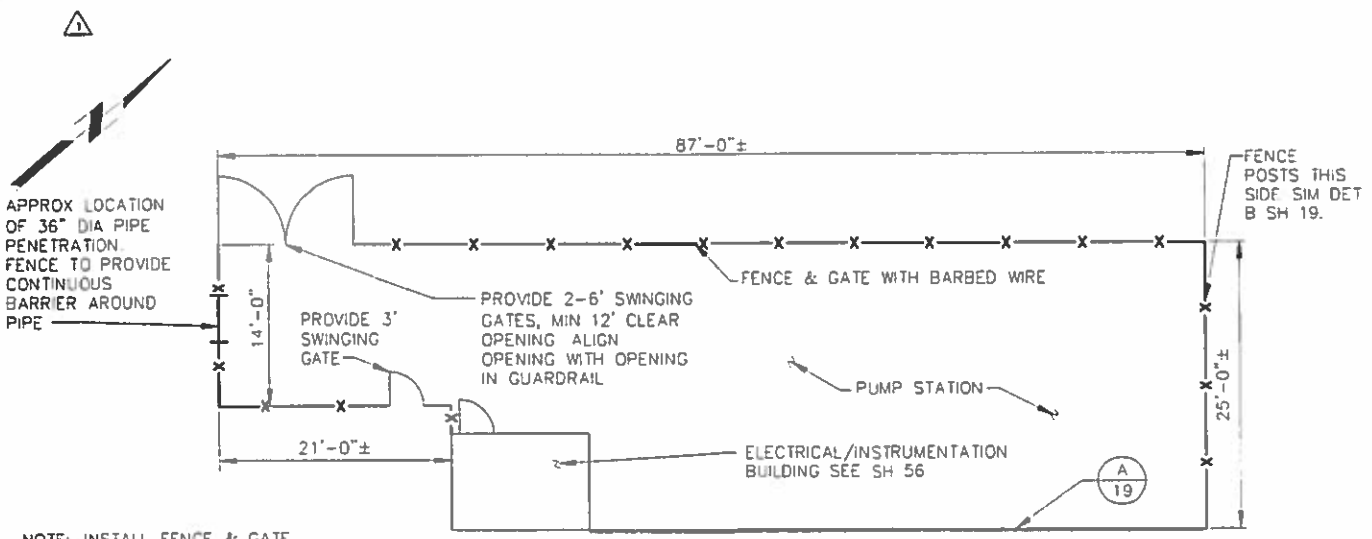

FENCING SITE PLAN, PUMP STATION
SCALE: 1/8" = 1'

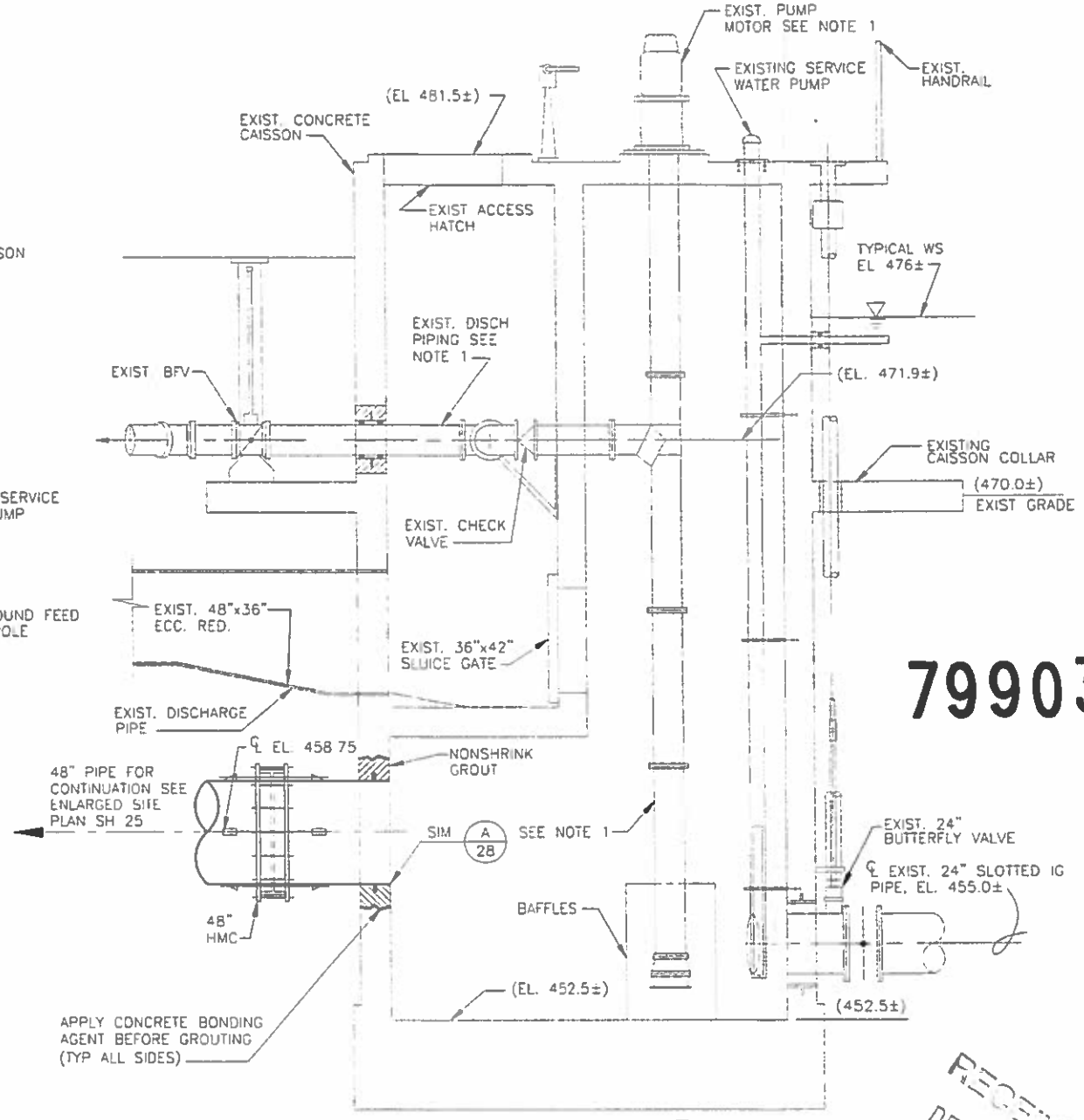

SECTION 1/29
SCALE: 3/8" = 1'-0"



NOTE: INSTALL FENCE AND GATE WITH BARBED WIRE TO NEW FILTER NO. 1 AND FILTER NO. 2 CONTROL STRUCTURES.

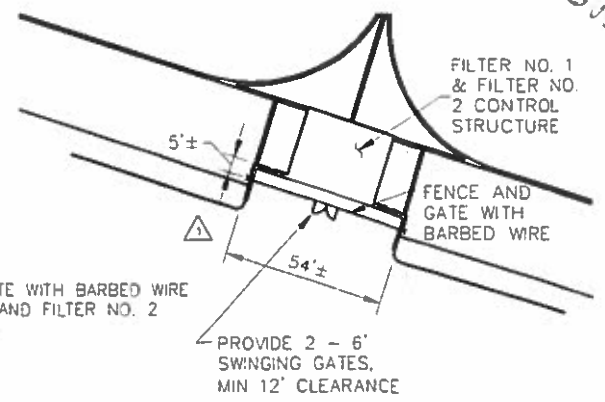

FENCING SITE PLAN, FILTERS 1 & 2
SCALE: 1" = 20'

WARNING
0 1/2" 1"

IF THIS BAR DOES NOT MEASURE 1" THEN DRAWING IS NOT TO SCALE

799037

This drawing was originally signed by the indicated City of Salem staff.

CITY OF SALEM

REVIEWED BY S. OLDS 04/22/01
APPROVED BY KEITH WENSEMONT 04/22/01



B & V PROJECT NO: 28495.0307

CONFORMING TO CONSTRUCTION RECORDS

THIS DRAWING WAS ORIGINALLY SEALED BY RANDALL J. KRUEGER, A REGISTERED PROFESSIONAL ENGINEER IN THE STATE OF OREGON NO. 15639

NO.	DESCRIPTION	DATE	BY	APP'D
1	LAST WEST ACCESS RAMP	12-01	DMC	RJK
2	REVISION FOR FILTER	01/03	DMC	RJK
3	CONVERTED TO CONSTRUCTION RECORDS	01/03	DMC	RJK
4	SEE CONSTRUCTION RECORDS			
5	ON ORDER SHEET (SHEET 1)			

CITY OF SALEM		PUBLIC WORKS DEPARTMENT	
GENE ISLAND TREATMENT FACILITY IMPROVEMENTS	NO. 1 RECONSTRUCTION AND PUMP STATION	EXISTING IG CAISSON AND SECURITY FENCING	
CHKD: RJK	FILE NO: 799037-29.DWG		
APPR: RJK	SHEET 29 OF 76		

**Application for a Groundwater
Registration Modification
(GR-3507)**

**A Water Right in the
Name of City of Salem
Point of Appropriation Map**

**Marion County, Oregon
Township 9 South,
Range 1 West (W.M.)**

LEGEND

- ⊙ Authorized Point of Appropriation (POA)
- Proposed Point of Appropriation (POA)
- Water Main Line
- ⊞ Donation Land Claim (DLC)
- ⊞ Government Lot (GL)
- All Other Features**
- ▭ County Boundary
- ▭ Tax Lot
- Railroad
- Major Road
- ~ Watercourse
- Waterbody

RECEIVED
DEC 17 2019
CWED

DISCLAIMER

This map was prepared for the purpose of identifying the location of a water right only and it is not intended to provide legal dimensions or location of property ownership lines.

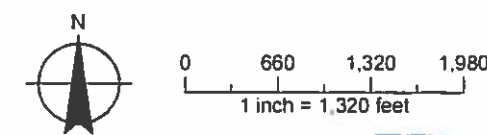

Date: September 5, 2019
Data Sources: BLM, USGS, ESRI, OWRD
City of Salem, Marion Co

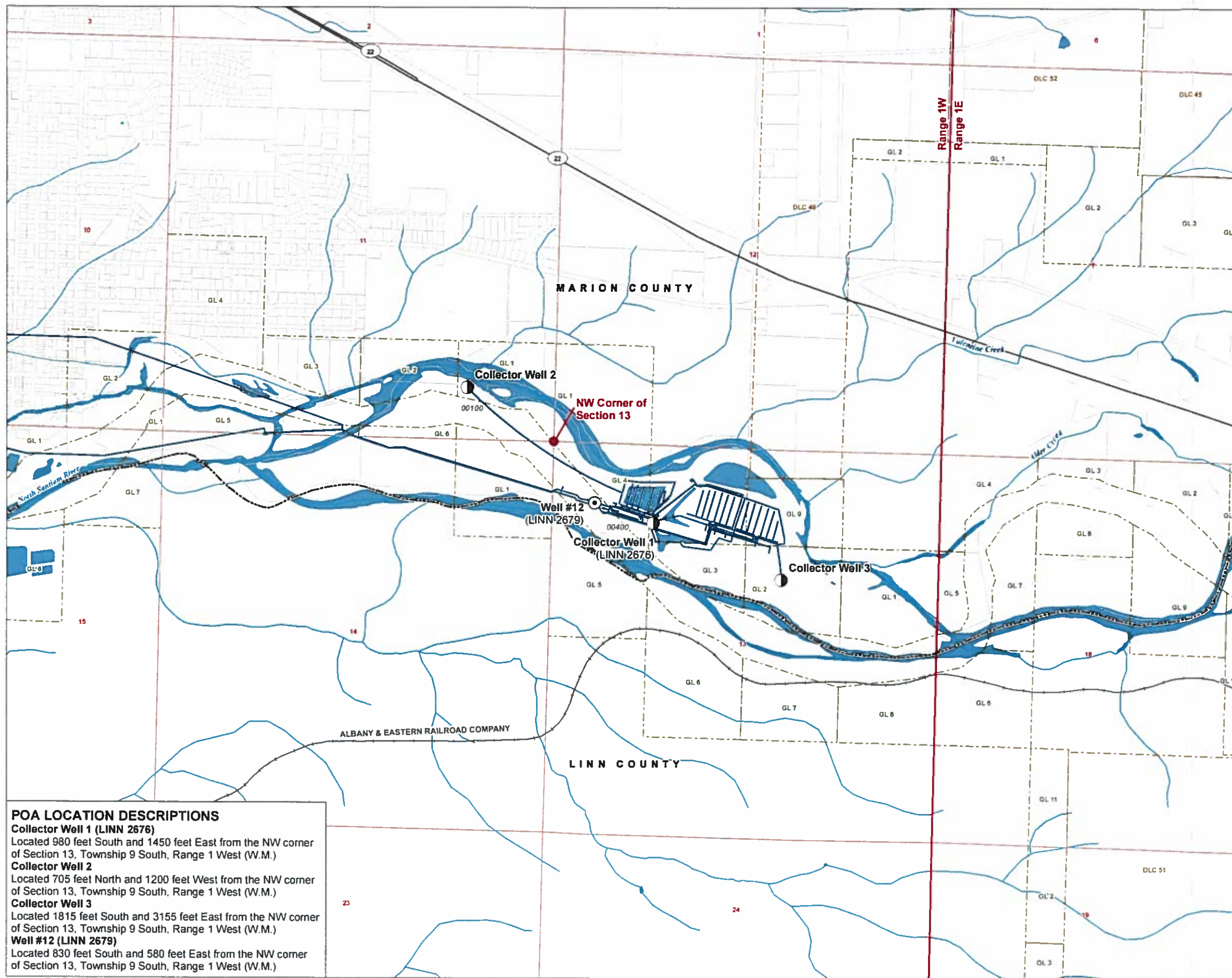

POA LOCATION DESCRIPTIONS
Collector Well 1 (LINN 2676)
 Located 980 feet South and 1450 feet East from the NW corner of Section 13, Township 9 South, Range 1 West (W.M.)
Collector Well 2
 Located 705 feet North and 1200 feet West from the NW corner of Section 13, Township 9 South, Range 1 West (W.M.)
Collector Well 3
 Located 1815 feet South and 3155 feet East from the NW corner of Section 13, Township 9 South, Range 1 West (W.M.)
Well #12 (LINN 2679)
 Located 830 feet South and 580 feet East from the NW corner of Section 13, Township 9 South, Range 1 West (W.M.)

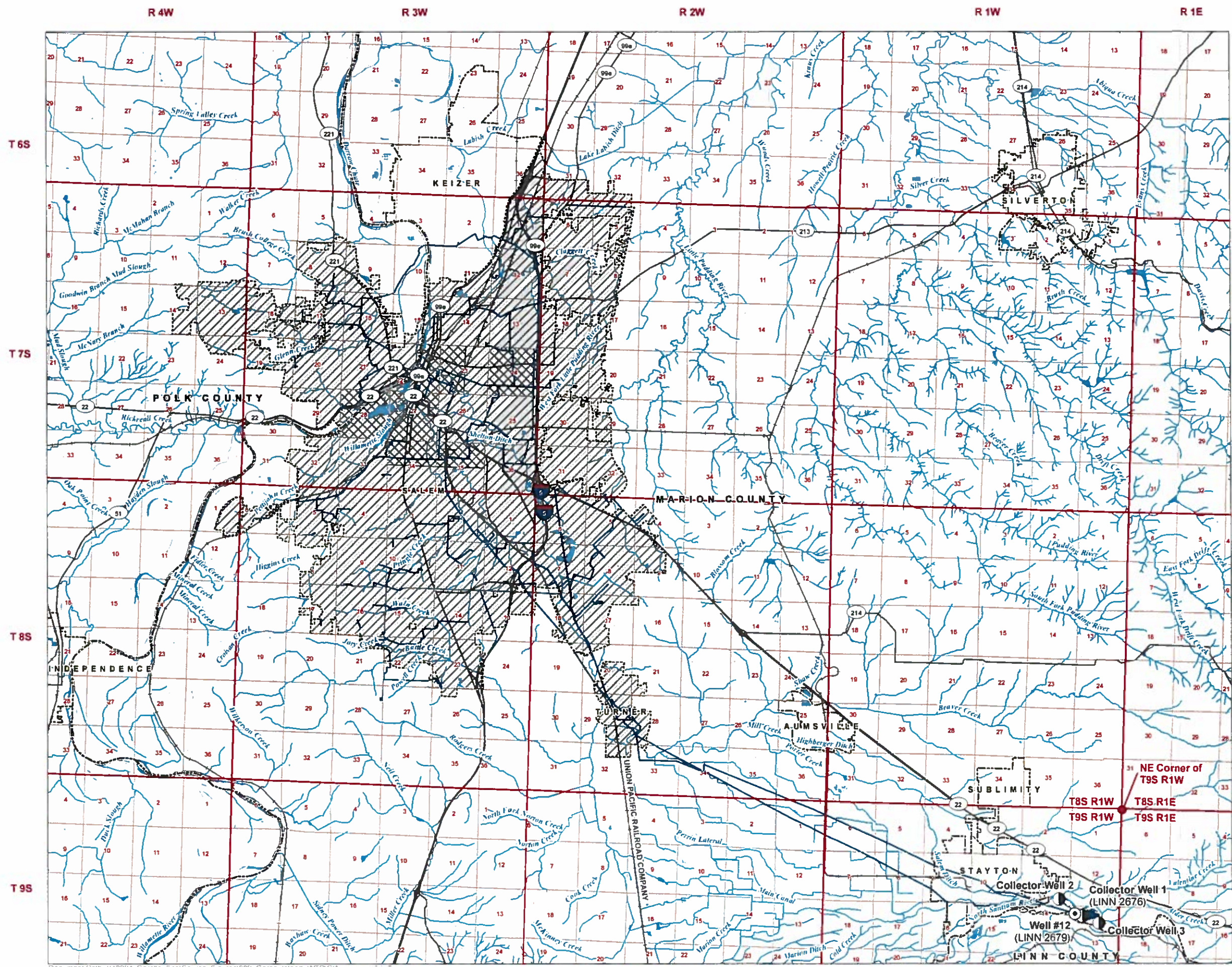

Application for a Groundwater Registration Modification (GR-3507)

A Water Right in the Name of City of Salem
 Place of Use Map
 Marion and Polk County, Oregon

- LEGEND**
- ⊙ Authorized Point of Appropriation (POA)
 - Proposed Point of Appropriation (POA)
 - Water Main Line
 - ▨ Authorized Place of Use (POU)
 - ▩ Proposed Place of Use (POU)
 - ⊞ Water Service Area
- All Other Features**
- ▭ County Boundary
 - ▭ City Boundary
 - Railroad
 - Major Road
 - ~ Watercourse
 - Waterbody

RECEIVED
 DEC 15 2019
 OWRD

DISCLAIMER
 This map was prepared for the purpose of identifying the location of a water right only and it is not intended to provide legal dimensions or location of property ownership lines.

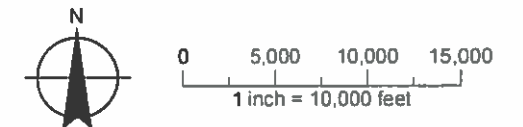

Date October 10 2019
 Data Sources BLM, USGS, ESRI, OWRD, City of Salem, Marion Co

**Application for a Groundwater
Registration Modification
(GR-3510)**

**A Water Right in the
Name of City of Salem
Point of Appropriation Map**

**Marion County, Oregon
Township 9 South,
Range 1 West (W.M.)**

LEGEND

- ⊙ Authorized Point of Appropriation (POA)
- Proposed Point of Appropriation (POA)
- Water Main Line
- ▭ Donation Land Claim (DLC)
- ▭ Government Lot (GL)
- All Other Features**
- ▭ County Boundary
- Tax Lot
- Railroad
- Major Road
- Watercourse
- Waterbody

RECEIVED
DEC 17 2019
OWRD

DISCLAIMER

This map was prepared for the purpose of identifying the location of a water right only and it is not intended to provide legal dimensions or location of property ownership lines.

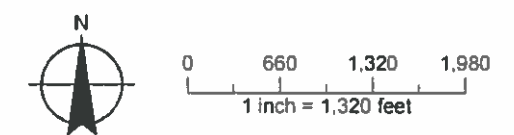

Date: September 5, 2019
Data Sources: BLM, USGS, ESRI, OWRD,
City of Salem, Marion Co

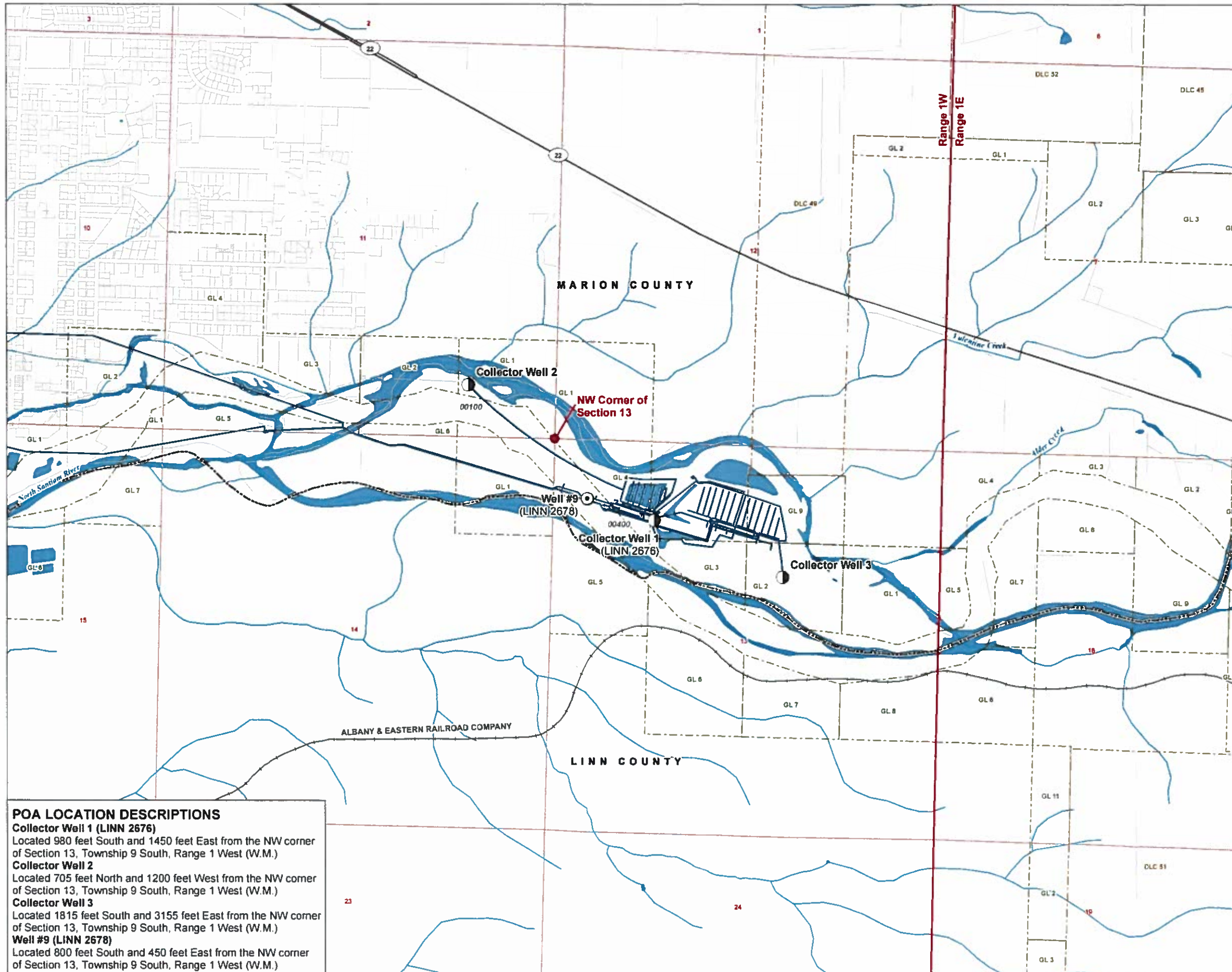

POA LOCATION DESCRIPTIONS

- Collector Well 1 (LINN 2676)**
Located 980 feet South and 1450 feet East from the NW corner of Section 13, Township 9 South, Range 1 West (W.M.)
- Collector Well 2**
Located 705 feet North and 1200 feet West from the NW corner of Section 13, Township 9 South, Range 1 West (W.M.)
- Collector Well 3**
Located 1815 feet South and 3155 feet East from the NW corner of Section 13, Township 9 South, Range 1 West (W.M.)
- Well #9 (LINN 2678)**
Located 800 feet South and 450 feet East from the NW corner of Section 13, Township 9 South, Range 1 West (W.M.)

R 4W

R 3W

R 2W

R 1W

R 1E

T 6S

T 7S

T 8S

T 9S

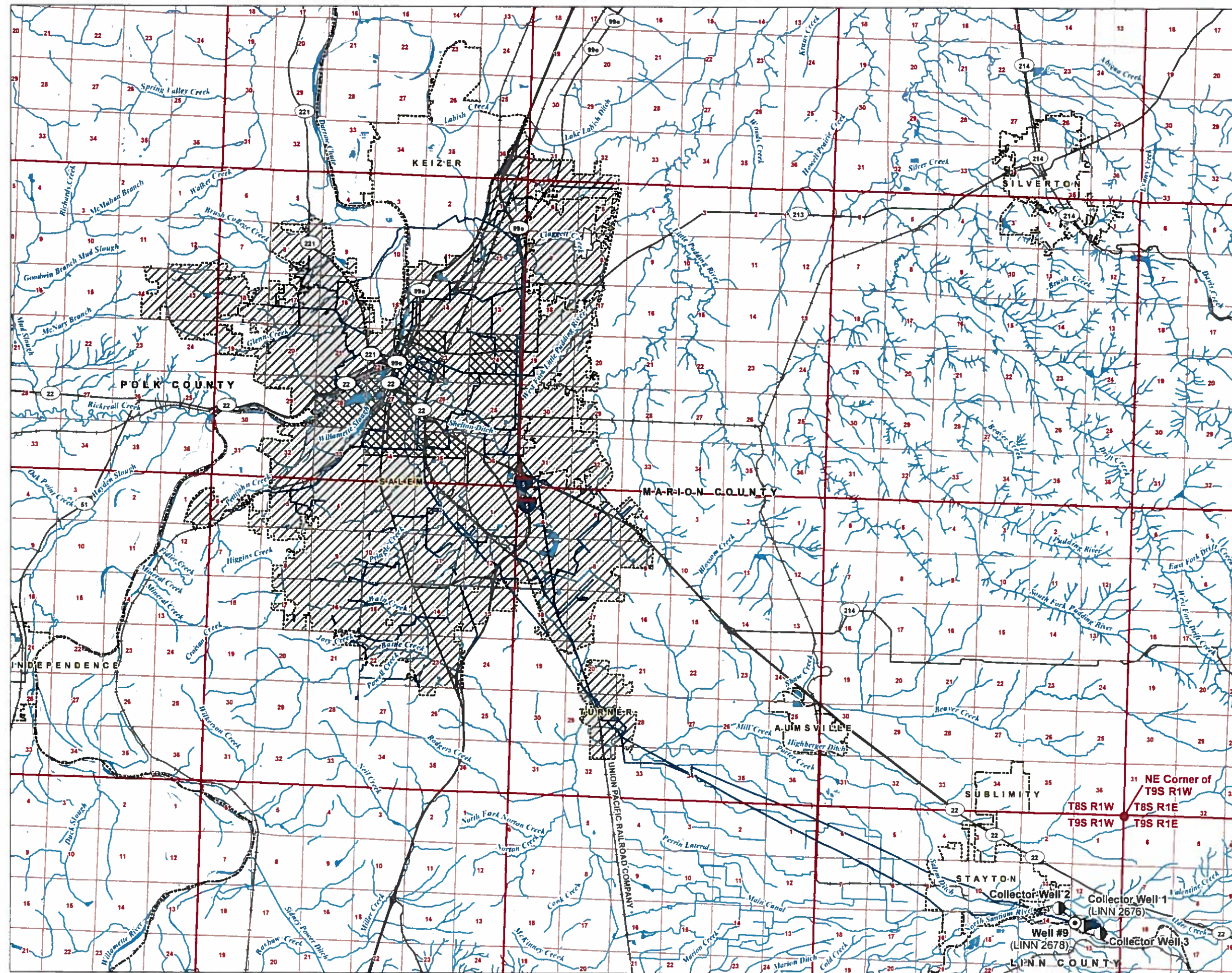

**Application for a Groundwater
Registration Modification
(GR-3510)**

**A Water Right in the
Name of City of Salem
Place of Use Map**

Marion and Polk County, Oregon

LEGEND

- ⊙ Authorized Point of Appropriation (POA)
- Proposed Point of Appropriation (POA)
- Water Main Line
- ▨ Authorized Place of Use (POU)
- ▧ Proposed Place of Use (POU)
- ⊞ Water Service Area
- All Other Features**
- ▭ County Boundary
- ⊞ City Boundary
- Railroad
- Major Road
- ~ Watercourse
- Waterbody

RECEIVED
DEC 17 2019
OWRD

DISCLAIMER

This map was prepared for the purpose of identifying the location of a water right only and it is not intended to provide legal dimensions or location of property ownership lines.

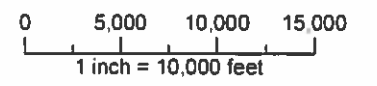
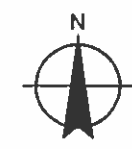

Date August 21, 2019
Data Sources BLM, USGS, ESRI, OWRD
City of Salem, Marion Co



Township 05 Range 17 W.M.
North

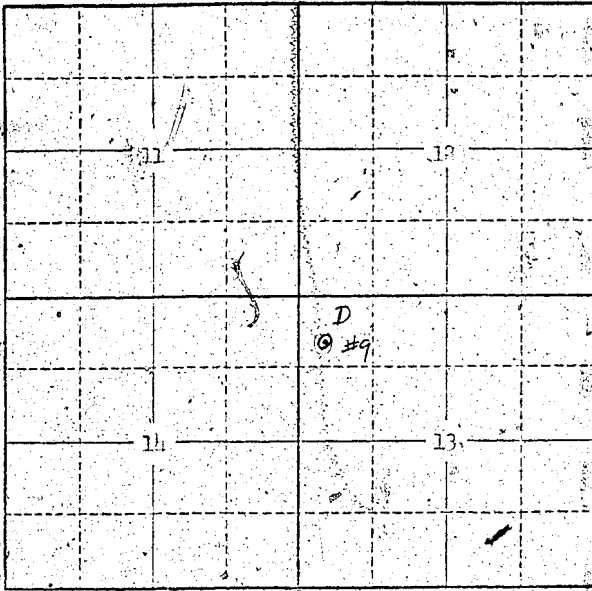

Locate well and acreage of irrigated land on plat.
Scale: 2" = 1 Mile

STATE OF OREGON

County of MARION

ss.

I, JOHN L. GEREN, being first duly sworn, do hereby certify that I have read the foregoing Registration Statement and that all of the items therein contained are true to the best of my knowledge and belief.

John L. Geren, Regr.
(Signature of Registrant)

Subscribed and sworn to before me this 30 day of July, 1956

My commission expires 1961

W. H. ...
(Notary Public)

(SEAL)

CERTIFICATE OF REGISTRATION

STATE OF OREGON

County of Marion

ss.

This is to certify that the foregoing Registration Statement was received in the office of the State Engineer on the 31st day of July, 1956, at 5:00 o'clock P.M. and has been duly recorded in said office in Book No. 13 of Registration Statements on page GR 3230

Witness my hand this 20th day of July, 1959

W. H. ...
(State Engineer)

By _____ (Deputy)

\$ 26.00