

Township 11 S Range 4 W W.M.

North

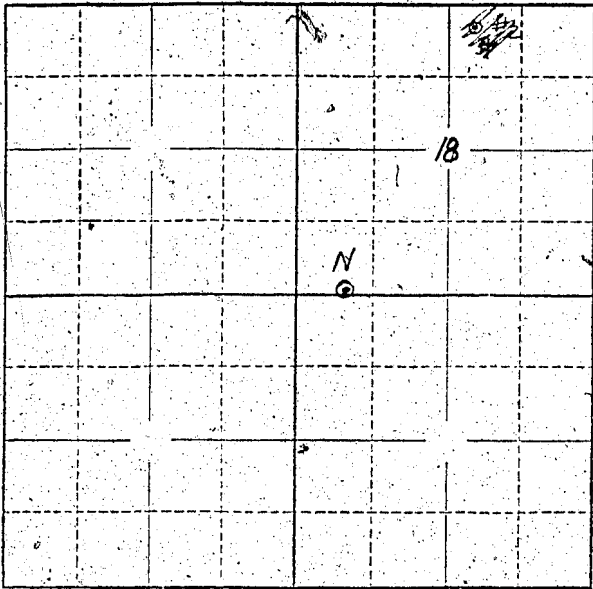

Locate well and acreage of irrigated land on plat.
Scale: 2" = 1 Mile

STATE OF OREGON }
County of Benton } ss.

I, A. L. Guerber, being first duly sworn, do hereby certify that I have read the foregoing Registration Statement and that all of the items therein contained are true to the best of my knowledge and belief.

A. L. Guerber
(Signature of Registrant)

Subscribed and sworn to before me this 31st day of July, 1958.

My commission expires Sept. 29, 1961

Thayer B. ...
(Notary Public)

(SEAL)

CERTIFICATE OF REGISTRATION

STATE OF OREGON }
County of Marion } ss.

This is to certify that the foregoing Registration Statement was received in the office of the State Engineer on the 1st day of August, 1958, at 11:00 o'clock A. M. and has been duly recorded in said office in Book No. 14 of Registration Statements on page GR-3310

Witness my hand this 20th day of August, 1959

Wm. A. Stensley
(State Engineer)

By ...
(Deputy)

\$24.⁰⁰