

Township 1 N Range 3 W W.M.
North

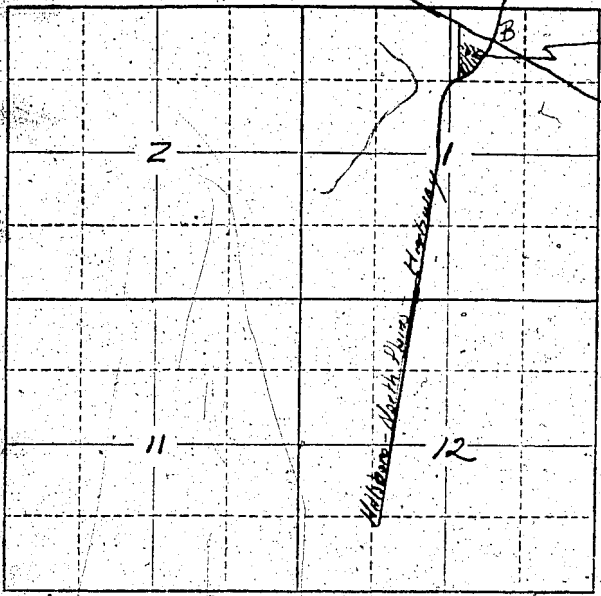

Locate well and acreage of irrigated land on plat.
Scale: 2" = 1 Mile

STATE OF OREGON

County Washington

ss.

I, Ernest Meyer, being first duly sworn, do hereby certify that I have read the foregoing Registration Statement and that all of the items therein contained are true to the best of my knowledge and belief.

Ernest Meyer
(Signature of Registrant)

Subscribed and sworn to before me this 30 day of July, 1938

My commission expires

Nelson F. De Fries
(Notary Public)

(SEAL)

CERTIFICATE OF REGISTRATION

STATE OF OREGON

County of Marion

ss.

This is to certify that the foregoing Registration Statement was received in the office of the State Engineer on the _____ day of _____, 1938, at _____ o'clock _____ M. and has been duly recorded in said office in Book No. 14 of Registration Statements on page GR 3280

Witness my hand this 20 day of July, 1938

[Signature]
(State Engineer)

By _____
(Deputy)

7/500