

Township 6N Range 35E W.M.

North

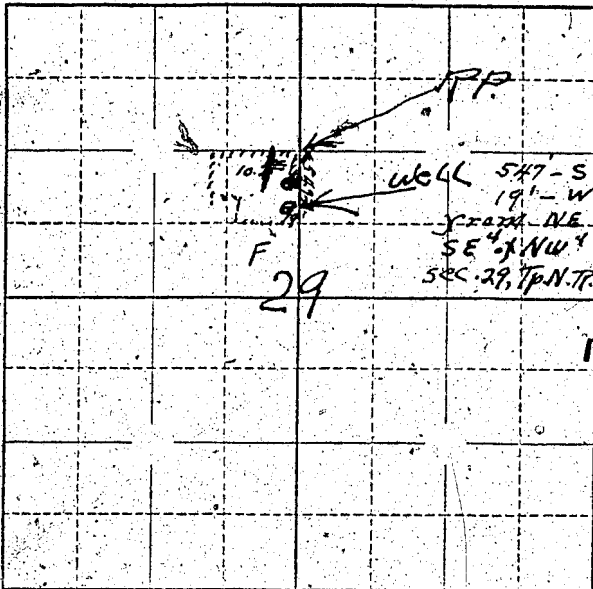

Locate well and acreage of irrigated land on plat.

Scale: $\frac{1}{4}$ " = 1 Mile
 $\frac{1}{8}$ " = 1 Mile

STATE OF OREGON

County of _____ ss.

I, _____, being first duly sworn, do hereby certify that I have read the foregoing Registration Statement and that all of the items therein contained are true to the best of my knowledge and belief.

[Handwritten Signature]
(Signature of Registrant)

Subscribed and sworn to before me this 21st day of July, 1958

My commission expires July 26 1962
(Notary Public)

(SEAL)

CERTIFICATE OF REGISTRATION

STATE OF OREGON }
County of Marion } ss.

This is to certify that the foregoing Registration Statement was received in the office of the State Engineer on the _____ day of _____, 19____, at _____ o'clock _____ M. and has been duly recorded in said office in Book No. 14 of Registration Statements on page GR-3285

Witness my hand this 20 day of July, 1958

\$15.00

[Handwritten Signature]
(State Engineer)

By _____ (Deputy)