

Township 17S Range 3W W.M.
 North

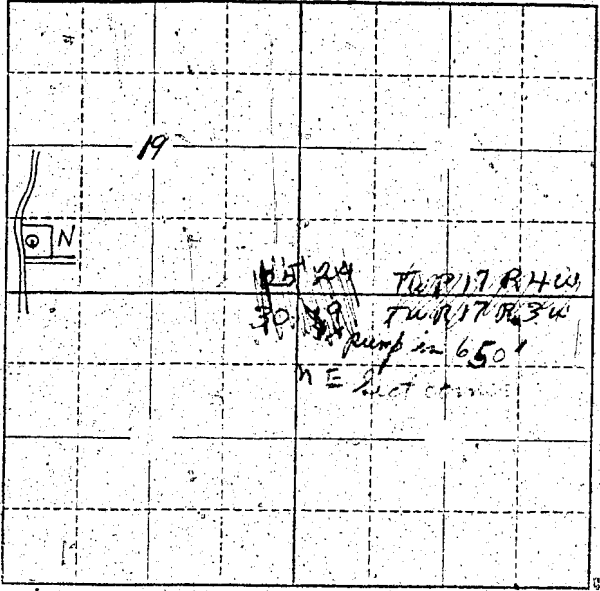

Locate well and acreage of irrigated land on plat.
 Scale: 2" = 1 Mile

STATE OF OREGON

County of Lane } ss.

I, Harris W. Hand, being first duly sworn, do hereby certify that I have read the foregoing Registration Statement and that all of the items thereof contained are true to the best of my knowledge and belief.

Harris W. Hand
 (Signature of Registrant)

Subscribed and sworn to before me this 14th day of July, 1959

My commission expires NOTARY PUBLIC FOR OREGON
 My Commission Expires Oct. 16, 1959

Robert E. ...
 (Notary Public)

(SEAL)

CERTIFICATE OF REGISTRATION

STATE OF OREGON }
 County of Marion } ss.

This is to certify that the foregoing Registration Statement was received in the office of the State Engineer on the _____ day of _____, 19____ at _____ o'clock _____ M. and has been duly recorded in said office in Book No. 14 of Registration Statements on page GR 3291

Witness my hand this 20th day of July, 1959

[Signature]
 (State Engineer)

By _____ (Deputy)