

North

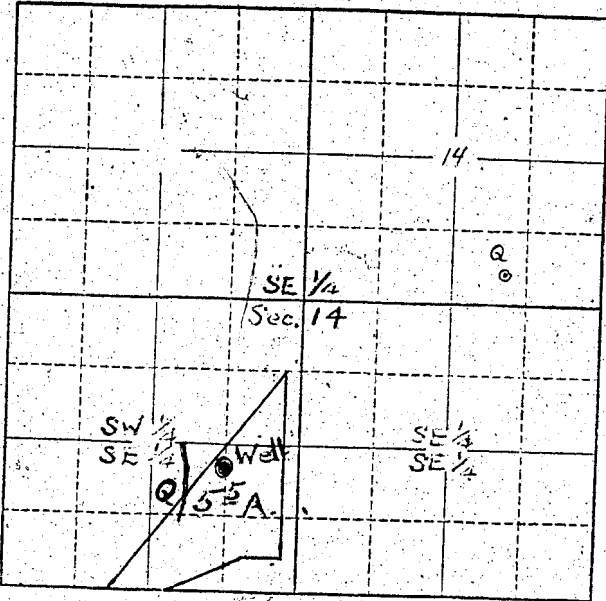

Locate well and acreage of irrigated land on plat.

Scale: 2" = 1/4 Mile

STATE OF OREGON

County of Clackamas

ss.

WE, Harold B. Schroeder & Mary C. Schroeder, being first duly sworn, do hereby certify that I have read the foregoing Registration Statement and that all of the items therein contained are true to the best of my knowledge and belief.

Harold B. Schroeder
Mary C. Schroeder

(Signature of Registrant)

Subscribed and sworn to before me this 21st day of July, 1959

My commission expires 1960

(Notary Public)

(SEAL)

CERTIFICATE OF REGISTRATION

STATE OF OREGON

County of Marion

ss.

This is to certify that the foregoing Registration Statement was received in the office of the State Engineer on the 1st day of July, 1959, at 10 o'clock A.M. and has been duly recorded in said office in Book No. 14 of Registration Statements on page GR-3308

Witness my hand this 20th day of July, 1959

#1500

Elmer A. [Signature]
(State Engineer)

By _____ (Deputy)