

Township 15 Range 2E, W.M.

North

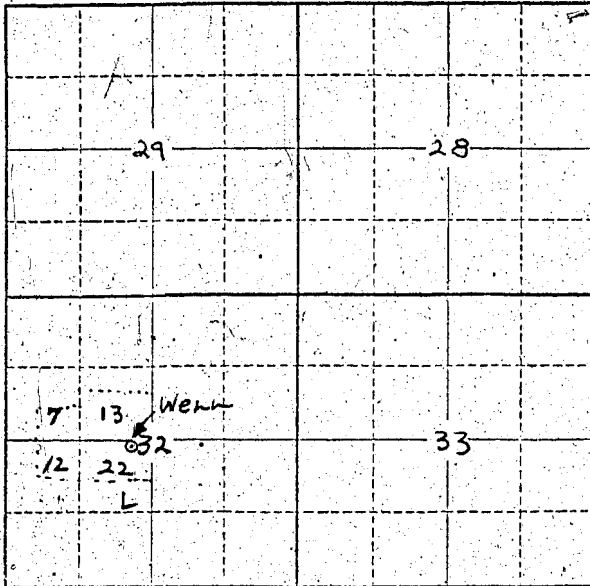

Locate well and acreage of irrigated land on plat.

Scale: 2" = 1 Mile

STATE OF OREGON

County of Clackamas } ss.

I, José Cartasigna, being first duly sworn, do hereby certify that I have read the foregoing Registration Statement and that all of the items therein contained are true to the best of my knowledge and belief.

José Cartasigna
(Signature of Registrant)

Subscribed and sworn to before me this 31 day of July, 1959

My commission expires _____
Gardner Cartasigna
(Notary Public)

(SEAL)

CERTIFICATE OF REGISTRATION

STATE OF OREGON }
County of Marion } ss.

This is to certify that the foregoing Registration Statement was received in the office of the State Engineer on the _____ day of _____, 1959, at _____ o'clock _____ M. and has been duly recorded in said office in Book No. 14 of Registration Statements on page GR-3335

Witness my hand this 20th day of August, 1959

W. W. Atchley
(State Engineer)

By _____
(Deputy)

18.60