

North

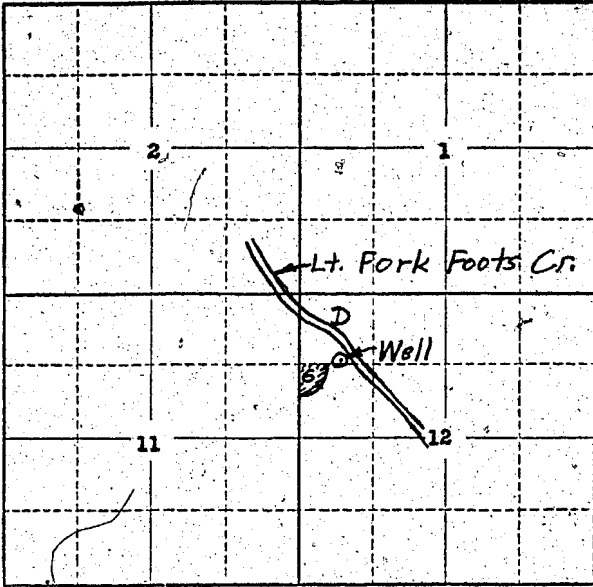

Locate well and acreage of irrigated land on plat.

Scale: 2" = 1 Mile

STATE OF OREGON

County of Marion

ss.

I, Mrs. Louise Bradford, being first duly sworn, do hereby certify that I have read the foregoing Registration Statement and that all of the items therein contained are true to the best of my knowledge and belief.

Mrs. Louise Bradford
(Signature of Registrant)

Subscribed and sworn to before me this 2nd day of July, 1958.

My commission expires April 10 - 1960

Allen S. Zimmell
(Notary Public)

(SEAL)

CERTIFICATE OF REGISTRATION

STATE OF OREGON

County of Marion

ss.

This is to certify that the foregoing Registration Statement was received in the office of the State Engineer on the 1 day of August, 1958, at 1:30 o'clock P.M. and has been duly recorded in said office in Book No. 14 of Registration Statements on page GR-3373

Witness my hand this 20th day of August, 1959.

Lewis A. Stanley
(State Engineer)

By _____
(Deputy)

GR - **3373**

\$15.00