

North

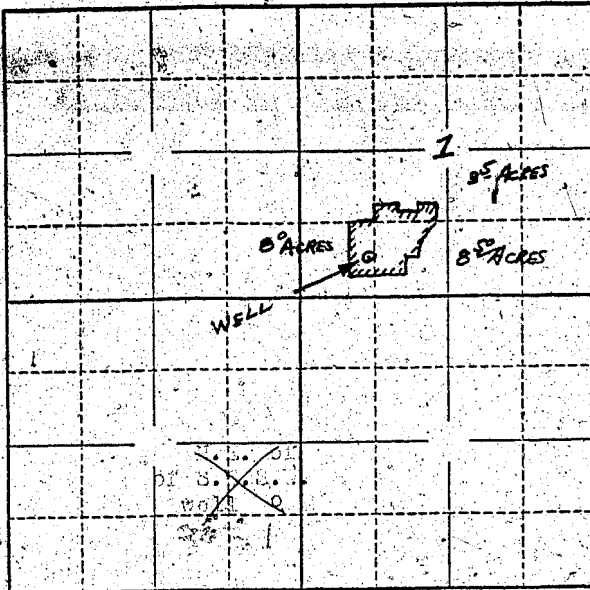

Locate well and acreage of irrigated land on plat.

Scale: 2" = 1 Mile

STATE OF OREGON

County of

} ss.

I, _____, being first duly sworn, do hereby certify that I have read the foregoing Registration Statement and that all of the items therein contained are true to the best of my knowledge and belief.

Book E. Head

(Signature of Registrant)

Subscribed and sworn to before me this _____ day of _____, 195____.
My Commission Expires April 10, 1962

My commission expires

William E. Schaefer

(Notary Public)

(SEAL)

CERTIFICATE OF REGISTRATION

STATE OF OREGON

County of Marion

} ss.

This is to certify that the foregoing Registration Statement was received in the office of the State Engineer on the _____ day of August, 1955, at 8:00 o'clock A.M. and has been duly recorded in said office in Book No. 17 of Registration Statements on page GR-4086

Witness my hand this 16th day of May, 1960.

LEWIS A. STANLEY

(State Engineer)

By

Max F. Rogers
Max F. Rogers

(Deputy)

\$15.00