

Cross Creek Bean Yard

Sec 24

Township 10S Range 3W, W.M. North

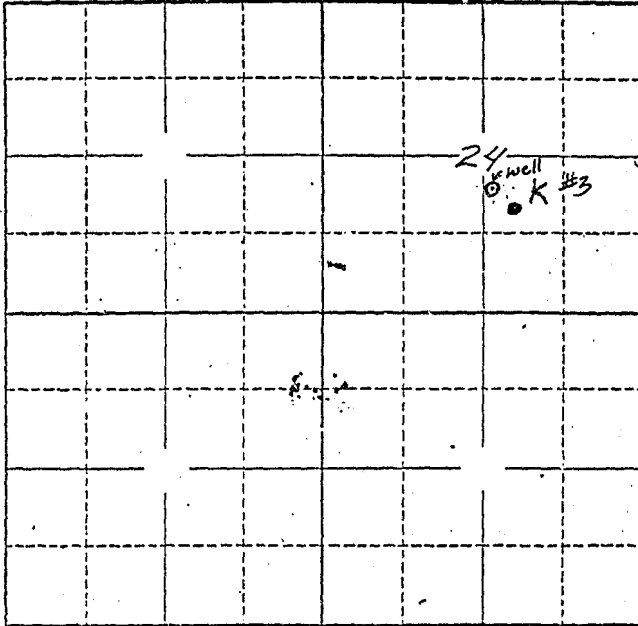

Locate well and acreage of irrigated land on plat. Scale: 2" = 1 Mile

STATE OF OREGON

County of Marion } ss.

I, Harvey Mitchell, being first duly sworn, do hereby certify that I have read the foregoing Registration Statement and that all of the items therein contained are true to the best of my knowledge and belief.

Harvey Mitchell (Signature of Registrant)

Subscribed and sworn to before me this 1 day of Aug, 1958

NOTARY PUBLIC FOR OREGON

My commission expires My Commission Expires April 19, 1960

Tom B. Fuller (Notary Public)

(SEAL)

CERTIFICATE OF REGISTRATION

STATE OF OREGON } ss. County of Marion

This is to certify that the foregoing Registration Statement was received in the office of the State Engineer on the 4th day of August, 1958, at 8:00 o'clock A.M. and has been duly recorded in said office in Book No. 17 of Registration Statements on page GR 4145

Witness my hand this 5th day of August, 1958

State Engineer (Signature)

By (Deputy)

\$21.00