

Township 17 South Range 3 West, W.M.  
18 South North 3 West

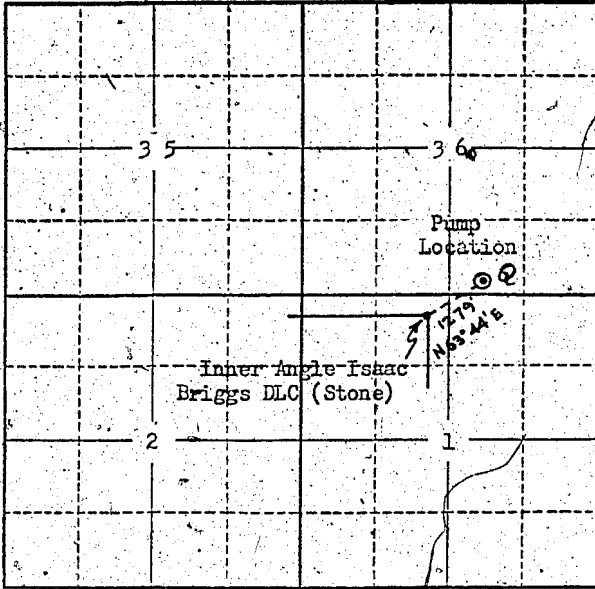

Locate well and acreage of irrigated land on plat.  
Scale: 2" = 1 Mile

STATE OF OREGON

County of Lane

ss.

THE BOOTH-KELLY LUMBER COMPANY

I, Eliot H. Jenkins, President, being first duly sworn, do hereby certify that I have read the foregoing Registration Statement and that all of the items therein contained are true to the best of my knowledge and belief.

THE BOOTH-KELLY LUMBER COMPANY,

*Eliot H. Jenkins*, President  
(Signature of Registrant)

Subscribed and sworn to before me this 31st day of July, 1958

My commission expires My Commission Expires April 13, 1962

(Notary Public)

(SEAL)

CERTIFICATE OF REGISTRATION

STATE OF OREGON

County of Marion

ss.

This is to certify that the foregoing Registration Statement was received in the office of the State Engineer on the 1st day of August, 1958, at 1:00 o'clock A.M. and has been duly recorded in said office in Book No. 14 of Registration Statements on page GR-3433

Witness my hand this 20th day of August, 1958

*Levin A. Stanley*  
(State Engineer)

By (Deputy)

3433

GR

\$ 20.00