

GR-3787

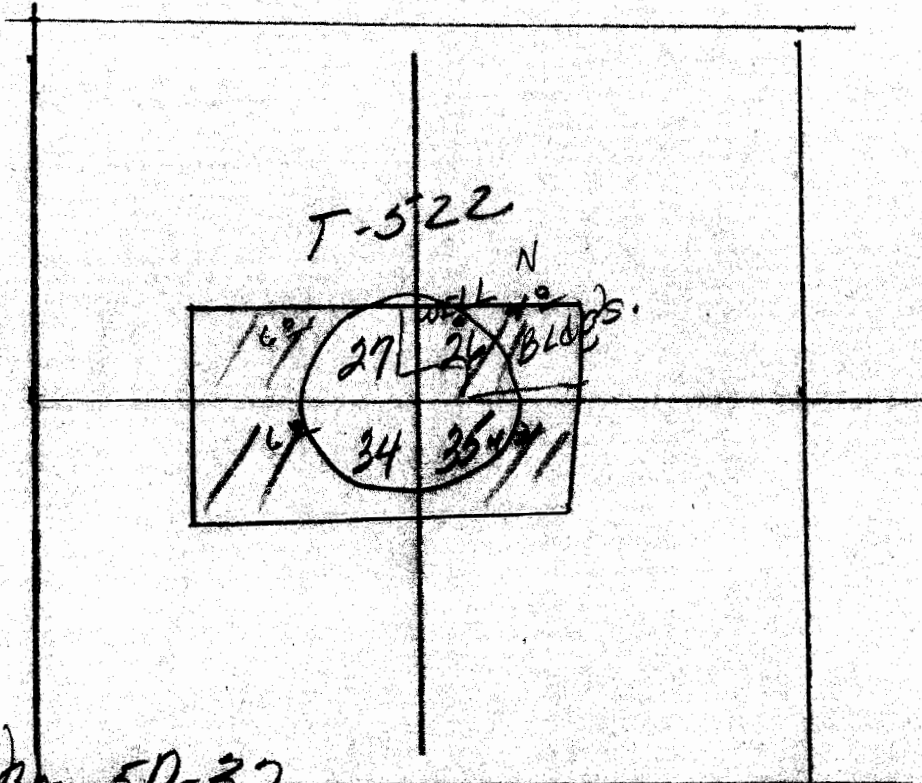

Map No. 50-32  
S. 27, 26, 34, 35 L. 115 R. 4W

Township 11 S. Range 4 E., W.M.

North

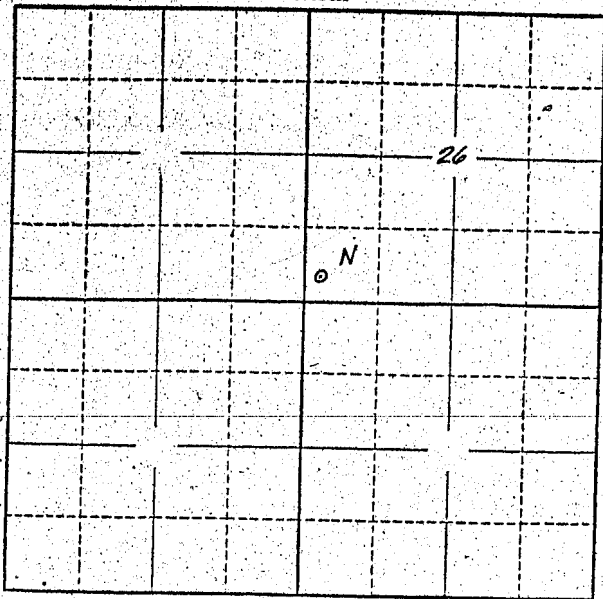

Locate well and acreage of irrigated land on plat.

Scale: 2" = 1 Mile

STATE OF OREGON

County of \_\_\_\_\_ } ss.

I, \_\_\_\_\_, being first duly sworn, do hereby certify that I have read the foregoing Registration Statement and that all of the items therein contained are true to the best of my knowledge and belief.

*Ronald P. George*  
(Signature of Registrant)

Subscribed and sworn to before me this 30<sup>th</sup> day of July, 1958

My commission expires \_\_\_\_\_  
NOTARY PUBLIC FOR OREGON.  
My Commission Expires 20 March 1961

*W. Walter Stuart*  
(Notary Public)

(SEAL)

**CERTIFICATE OF REGISTRATION**

STATE OF OREGON }  
County of Marion } ss.

This is to certify that the foregoing Registration Statement was received in the office of the State Engineer on the 1 day of August, 1958, at 8:00 o'clock A.M. and has been duly recorded in said office in Book No. 14 of Registration Statements on page GR 3449

Witness my hand this 15<sup>th</sup> day of September, 1959

*Lewis A. Stanley*  
(State Engineer)

By \_\_\_\_\_  
(Deputy)

GR **3449**

\$1500.