

Township 6N Range 35E, W.M.  
North

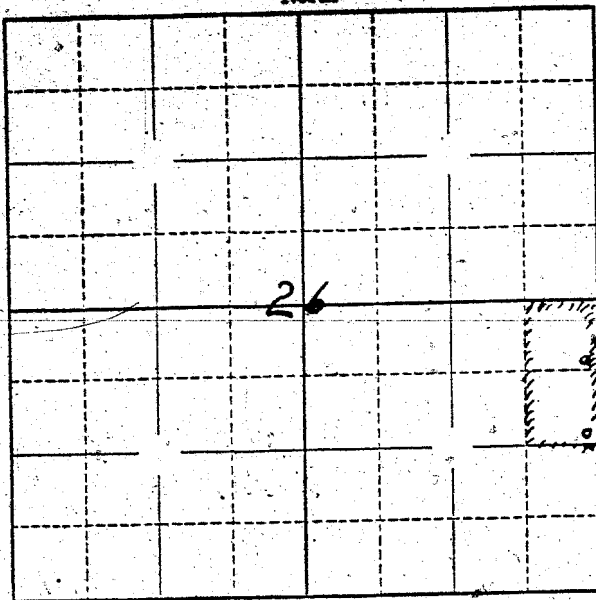

Locate well and acreage of irrigated land on plat.

Scale: 2" = 1 Mile  
4" = 1 M

STATE OF OREGON

County of Wasco

} ss.

I, Caron Weis being first duly sworn, do hereby certify that I have read the foregoing Registration Statement and that all of the items therein contained are true to the best of my knowledge and belief.

Caron Weis  
(Signature of Registrant)

Subscribed and sworn to before me this 30<sup>th</sup> day of July, 1958

My commission expires March 23, 1962

C. W. Winkler  
(Notary Public)

(SEAL)

**CERTIFICATE OF REGISTRATION**

STATE OF OREGÓN

County of Marion

} ss.

This is to certify that the foregoing Registration Statement was received in the office of the State Engineer on the 1 day of August, 1958, at 8:00 o'clock A. M. and has been duly recorded in said office in Book No. 14 of Registration Statements on page GR 3499

Witness my hand this 15<sup>th</sup> day of September, 1959

Laura A. Stanley  
(State Engineer)

By

(Deputy)

GR 3499

\$15.00