

Township 6N Range 35E, W.M.
North

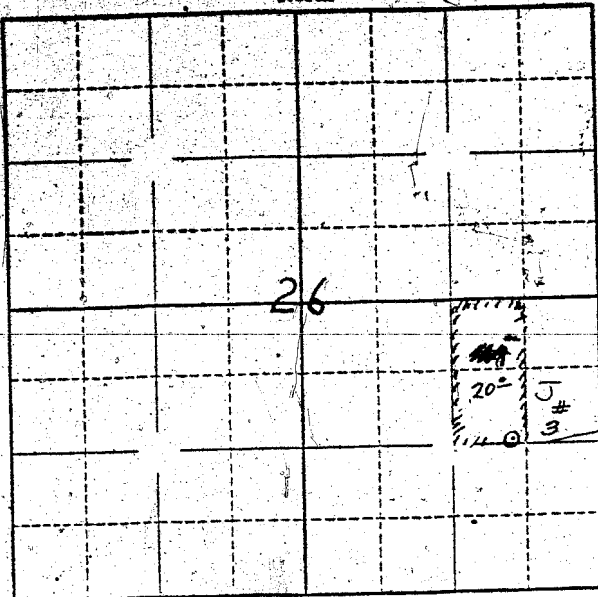

Locate well and acreage of irrigated land on plat.

Scale: ~~1/2~~ = 1 Mile
4" = 1 Mile

STATE OF OREGON

County of Wasco } ss.

I, Arnon J. Weis, being first duly sworn, do hereby certify that I have read the foregoing Registration Statement and that all of the items therein contained are true to the best of my knowledge and belief.

Arnon J. Weis
(Signature of Registrant)

Subscribed and sworn to before me this 30th day of July, 1958.

My commission expires March 23, 1962

R. W. Wankle
(Notary Public)

(SEAL)

CERTIFICATE OF REGISTRATION

STATE OF OREGON

County of Marion } ss.

This is to certify that the foregoing Registration Statement was received in the office of the State Engineer on the 1st day of August, 1958, at 8.00 o'clock A. M. and has been duly recorded in said office in Book No. 14 of Registration Statements on page 62-3500.

Witness my hand this 15th day of September, 1959.

Lewis A. Stanley
(State Engineer)

By _____ (Deputy)

\$15.00